

E-1 气缸头 Cylinder Head

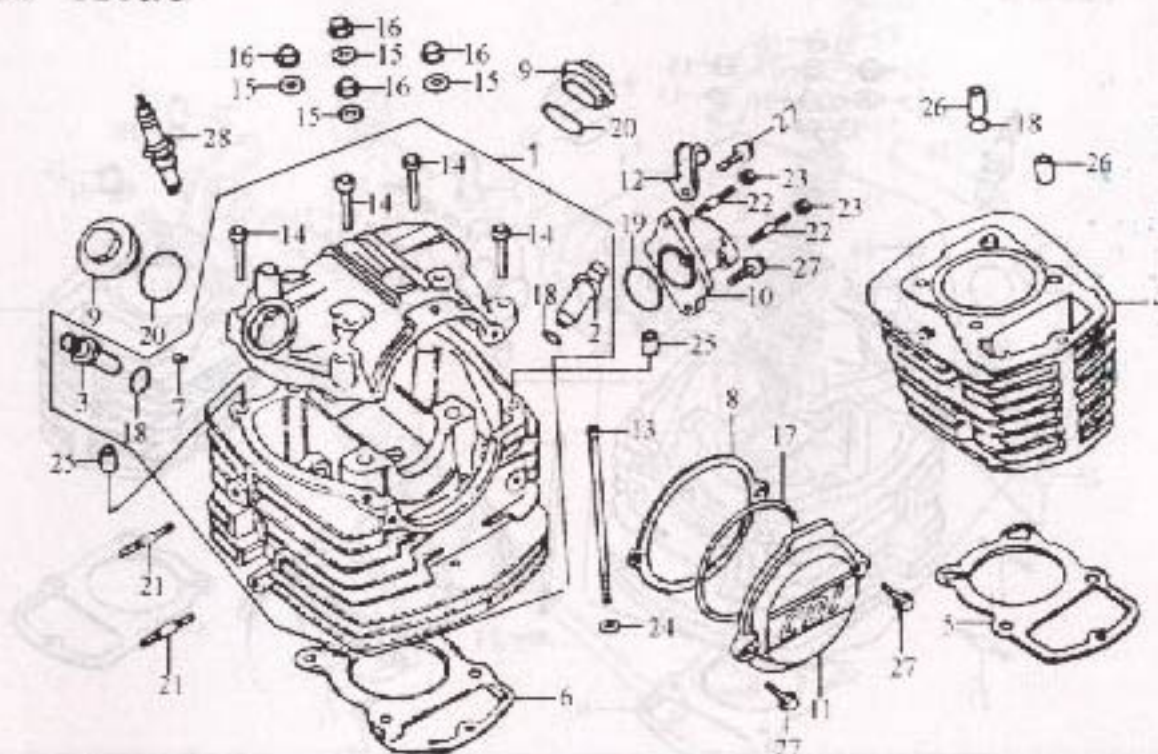

序号 Ref.No.	零部件代号 Part No.	零部件名称及规格	Part Name And Standard	数量 Quantity	备注 Remark
1	12100	气缸头组件	Cylinder Head Assy	1	
2	12101A	进气门导管	Intake Valve Guide	1	
3	12102A	排气门导管	Exhaust Valve Guide	1	
4	12200	气缸体	Cylinder Block	1	
5	12201	气缸体密封垫	Gasket	1	
6	12001	气缸头密封垫	Gasket	1	
7	12101	橡胶堵头	Rubber Piece	1	
8	12109	密封垫	Seal	1	
9	12112	气门盖	Valve Cover	2	
10	12003	进气管	Inlet Piece	1	
11	12108	左侧盖	Left Cover	1	
12	12005	高压线夹	Damp	1	
13	12008	螺栓 M6 × 110	Bolt M6 × 110	1	
14	GB/T 16674	螺栓 M6 × 35	Bolt M6 × 35	4	
15	12011	铜垫圈 8 × 17 × 2.2	Washer 8 × 17 × 2.2	4	
16	12007	盖形螺母 M8	Crown Nut	4	
17	12034	O形密封圈 75 × 2.5	O-Ring 75 × 2.5	1	
18	12103A	O形密封圈 10 × 1.6	O-Ring 10 × 1.6	3	
19	12004	O形密封圈 33.5 × 3	O-Ring 33.5 × 3	1	
20	12113	O形密封圈 35 × 3	O-Ring 35 × 3	2	
21	12017	双头螺栓 M6 × 35	Stud M6 × 35	2	
22	12035	双头螺栓 M6 × 28	Stud M6 × 28	2	
23	GB/T 6170	螺母 M6	Nut M6	2	
24	GB 848	铝垫圈 6.5 × 11.5 × 1.5	Washer 6.5 × 11.5 × 1.5	1	
25	12012	定位销 8 × 14	Pin 8 × 14	2	
26	12022	定位销 10 × 20	Pin 10 × 20	3	
27	GB5787-86	螺栓 M6 × 20	Bolt M6 × 20	4	
28	GB 6784	火花塞 T2198	Electric plug T2198	1	

E-2 凸轮轴 & 气门 Camshaft & Valve

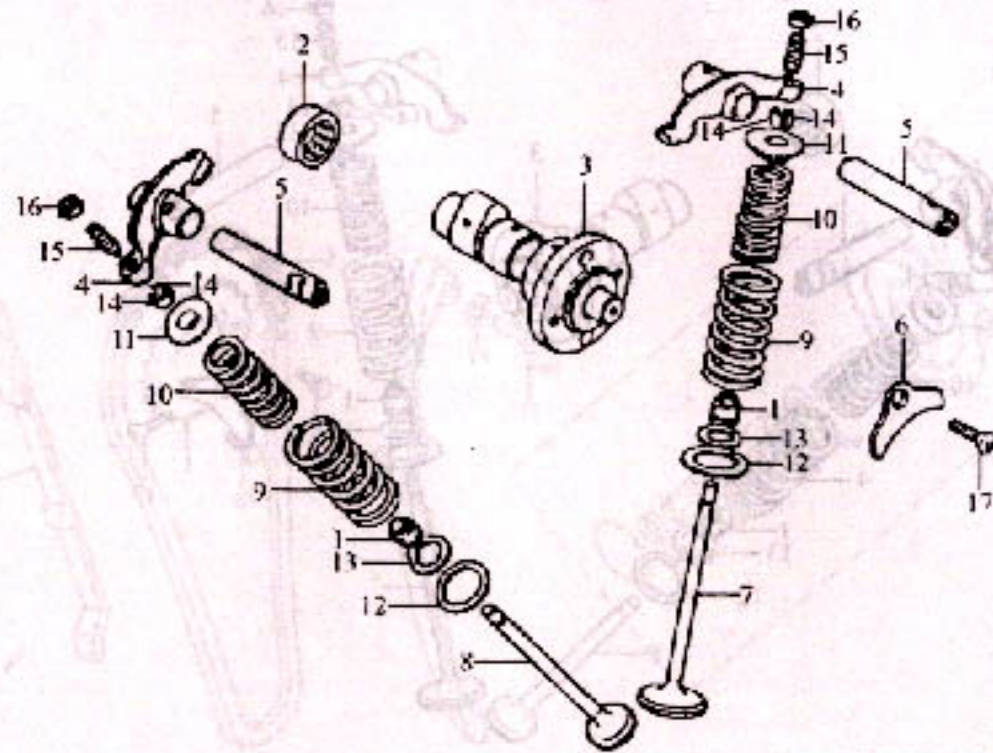

序号 Ref.No.	零部件代号 Part No.	零部件名称及规格	Part Name And Standard	数量 Quantity	备注 Remark
1	14004	挡油罩	Oil Seal	2	
2	14101	凸轮轴右轴承	Bearing	1	
3	14100	凸轮轴组件	Camshaft Set	1	
4	14303	摇臂	Rocker Arm	2	
5	14001	摇臂轴	Rocker Shaft	2	
6	14023	摇臂轴定位板	Locate Plate	1	
7	14002	进气门	Intake Valve	1	
8	14003	排气门	Exhaust Valve	1	
9	14006	气门外弹簧	Outer Spring	2	
10	14005	气门内弹簧	Inner Spring	2	
11	14007	弹簧座	Spring Seat	2	
12	14010	外弹簧座	Spring Seat	2	
13	14009	内弹簧座	Spring Seat	2	
14	14008	锁夹	Clamp	4	
15	14301	气门间隙调整螺钉	Adjusting Screw	2	
16	14302	气门间隙调整螺母	Adjusting Nut	2	
17	GB/T 819.1	螺钉 M6 × 16	Screw M6 × 16	1	

E-3 正时链条&张紧装置 Timing Chain & Tightening Device

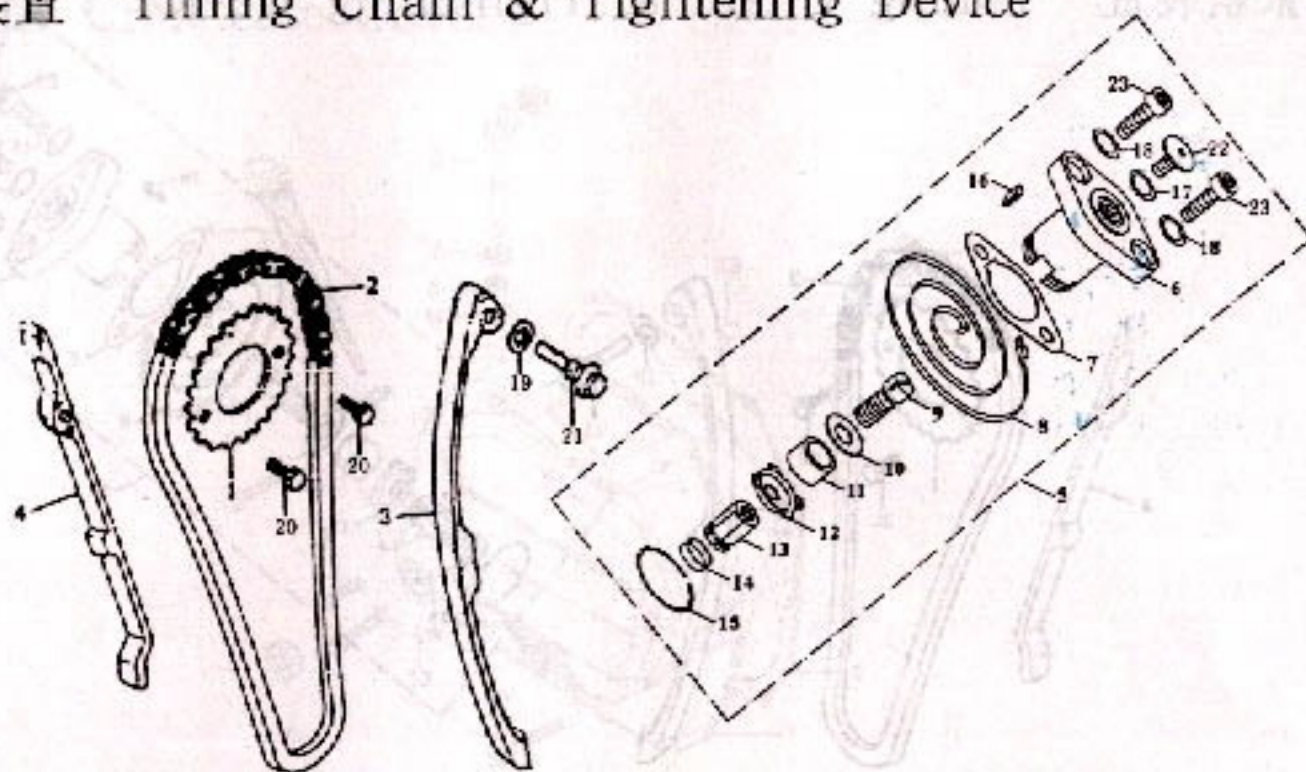

序号 Ref.No.	零部件代号 Part No.	零部件名称及规格	Part Name And Standard	数量 Quantity	备注 Remark
1	14011	正时从动链轮	Timing Driven Sprocket	1	
2	14200	正时链条	Timing Chain	1	
3	14402	链条调节板	Adjusting Plate	1	
4	14401	链条导向板	Guide plate	1	
5	14400B	自动调节器	Chain tensioner	1	
6	14400B-01	自动调节器壳体	Shell	1	
7	14412	自动调节器纸垫	Gasket	1	
8	14400B-02	自动调节器弹簧	Spring	1	
9	14400B-03	轴螺栓	Bolt	1	
10	14400B-04	垫圈	Washer	1	
11	14400B-05	轴套	Bush	1	
12	14400B-06	压盘	Clamp	1	
13	14400B-07	调节杆	Rod	1	
14	14400B-08	端盖	End, cap	1	
15	14400B-09	挡圈	Circlip	1	
16	14400B-10	橡胶堵塞	Seul	1	
17	14400B-11	O形密封圈 10 × 1.8	O-Ring 10 × 1.8	1	
18	14414	垫圈 6.5 × 12 × 1.5	Washer 8.5 × 14 × 1.5	2	
19	14415	铝垫 8.5 × 14 × 1.5	Washer 8.5 × 14 × 1.5	1	
20	GB 5783-86	螺栓 M6 × 10	Bolt M6 × 10	2	
21	14501	调节板定位销轴 M8 × 32.5	Locating Plate M8 × 32.5	1	
22	14400B-12	螺钉 M6 × 6	Screw M6 × 6	1	
23	GB 70-85	内六角螺钉 M6 × 16	Screw M6 × 16	2	

E-4 右曲轴箱盖 Right Crankcase Cover

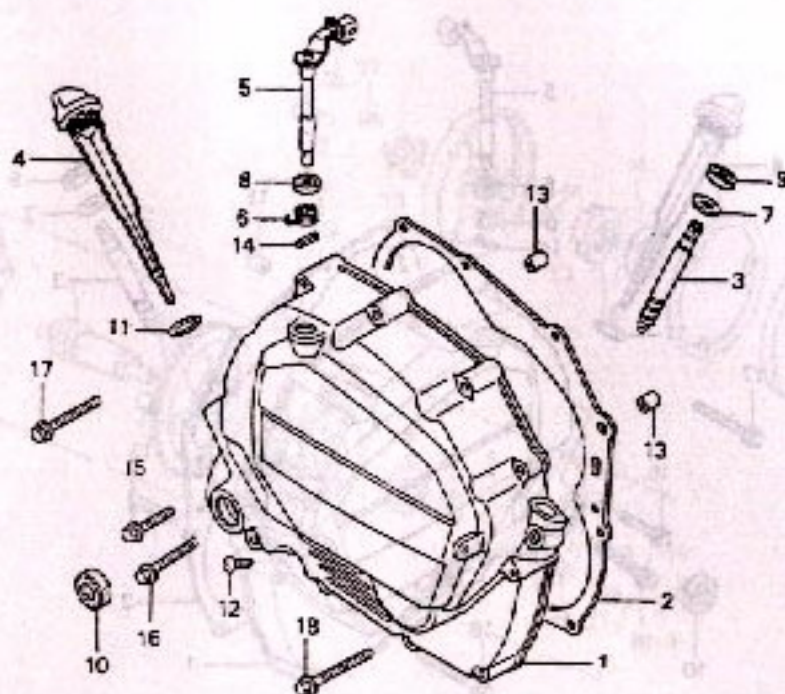

序号 Ref.No.	零部件代号 Part No.	零部件名称及规格 Part Name And Standard	数量 Quantity	备注 Remark
1	11401	右曲轴箱盖 Right Crankcase Cover	1	
2	11019	右曲轴箱盖密封垫 Gasket	1	
3	11404	转速输出轴 Transmission Shaft	1	
4	11402	油尺 Oil Lever	1	
5	11410	离合器操纵杆 Clutch Controlling Rod	1	
6	11411	复位弹簧 Reset Spring	1	
7	11406	垫圈 6.5 × 14 × 1 Washer 6.5 × 14 × 1	1	
8	11423	油封 12 × 22 × 5 Oil Seal 12 × 22 × 5	1	
9	11405	油封 6.5 × 14.5 × 7 Oil Seal 6.5 × 14.5 × 7	1	
10	11409	油封 16 × 28 × 7 Oil Seal 16 × 28 × 7	1	
11	11403	O形密封圈 18 × 3 O-Ring 18 × 3	1	
12	GB/T 820	螺钉 M5 × 25 Screw M5 × 25	2	
13	11424	定位销 8 × 14 Pin 8 × 14	1	
14	11020	挡销 3 × 11 Pin 3 × 11	1	
15	GB5787-86	螺栓 M6 × 25 Bolt M6 × 25	1	
16	GB5787-86	螺栓 M6 × 35 Bolt M6 × 35	1	
17	GB5787-86	螺栓 M6 × 40 Bolt M6 × 40	9	
18	GB5787-86	螺栓 M6 × 50 Bolt M6 × 50	1	

E-5 机油泵、机油滤清器 Oil pump & Oil filter

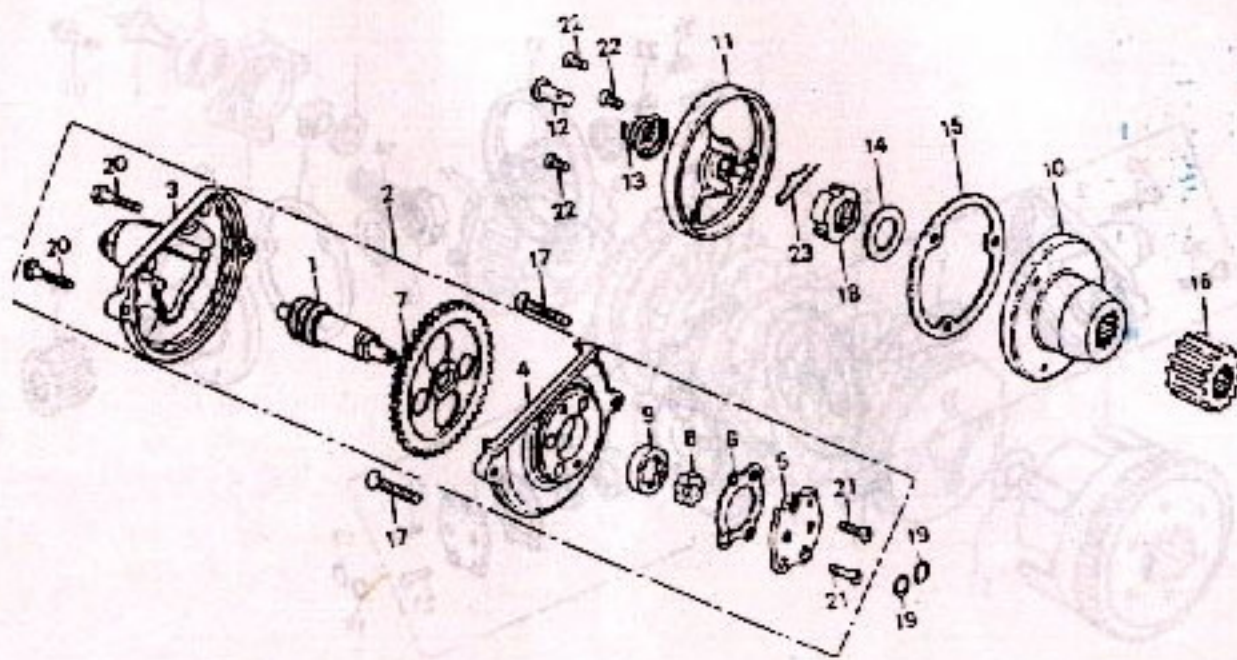

序号 Ref.No.	零部件代号 Part No.	零部件名称及规格	Part Name And Standard	数量 Quantity	备注 Remark
1	15002	传动轴	Driving Shaft	1	
2	15100	机油泵组件	Oil Pump	1	
3	15102	油泵上盖	Cover	1	
4	15101	油泵体	Body	1	
5	15108	油泵下盖	Pump Piece	1	
6	15003	密封垫	Gasket	1	
7	15005	油泵传动齿轮	Driving Gear	1	
8	15104	油泵内转子	Inner Rotator	1	
9	15105	油泵外转子	Extend Rotator	1	
10	15203	滤清器体	Filter Body	1	
11	15201	滤清器盖	Filter Cover	1	
12	15204	通油管	Oil Pipe	1	
13	15205	宝塔弹簧	Spring	1	
14	15206	碟形垫圈	Washer	1	
15	15202	密封垫	Gasket	1	
16	15206	初级主动齿轮	Driven Gear	1	
17	GB/T 819.1	螺钉 M6 × 30	Screw M6 × 30	2	
18	15009	圆螺母	Nut	1	
19	15010	O形圈 9.4 × 2.4	O-Ring 9.4 × 2.4	2	
20	GB/T 5782	螺栓 M5 × 20	Bolt M5 × 20	2	
21	GB/T 819.1	螺钉 M4 × 12	Screw M4 × 12	2	
22	GB/T 820	螺钉 M5 × 12	Screw M5 × 12	3	
23	15011	止退夹	Limit Pin	1	

E-6 离合器 Clutch

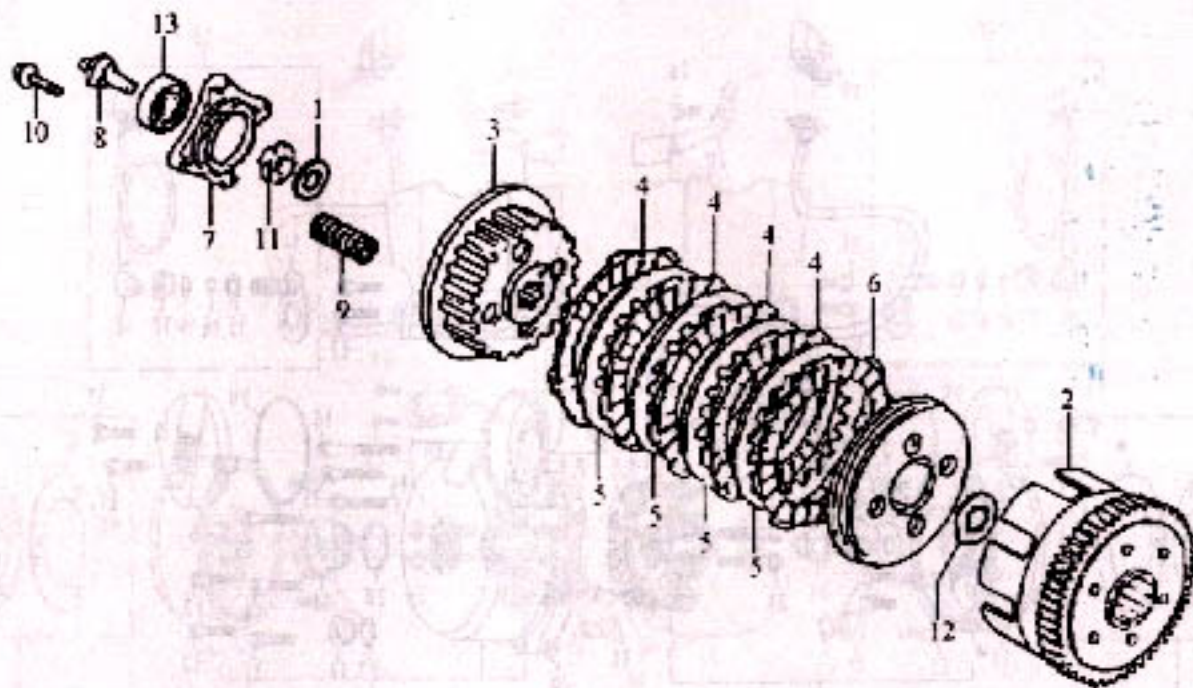

序号 Ref.No.	零部件代号 Part No.	零部件名称及规格	Part Name And Standard	数量 Quantity	备注 Remark
1	21002	蝶形垫圈	Spring Washer	1	
2	21100	离合器外罩组合	Driven Gear	1	
3	21019	离合器中心套	Clutch Gear	1	
4	21202	离合器摩擦盘	Clutch Piece	5	
5	21203	离合器板	Clutch Piece	4	
6	21201	离合器压盘	Locating Piece	1	
7	21020	离合器升板	Connecting Plate	1	
8	21021	离合器升杆	Rod	1	
9	21205	弹簧	Spring	4	
10	21022	法兰面螺栓 M6 × 20	Bolt M6 × 20	4	
11	21023	圆螺母	Nut	1	
12	21024	花键挡圈	Locating Piece	1	
13	GB 276	轴承 7000103	Bearing 7000103	1	

E-7 磁电机、左曲轴箱盖 Magneto Gen-set L.Crankcase Cover

磁电机 器台高 2-3

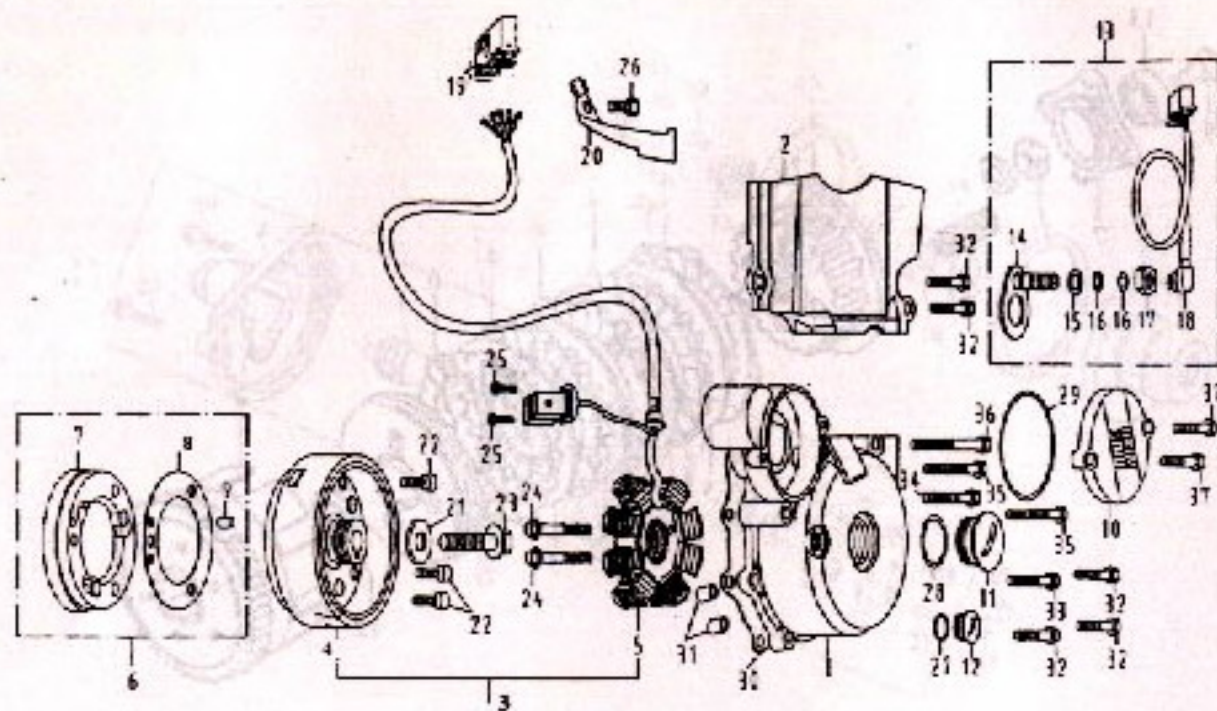

序号 Ref.No.	零部件代号 Part No.	零部件名称及规格 Part Name And Standard	数量 Quantity	备注 Remark
1	11025	左前盖	1	
2	11017	左后盖	1	
3	31000	磁电机组件	1	
4	31100	转子部件	1	
5	31200	定子部件	1	
6	31400	单向器	1	
7	31401	单向器主体	1	
8	31402	垫片	1	
9	31403	定位销 5 × 12	1	
10	11023	左上盖	1	
11	11302	大视孔盖	1	
12	11305	小视孔盖	1	
13	31300	档位显示器组件	1	
14	31301	档显触头	1	
15	31302	橡胶垫圈 10 × 16 × 0.5	1	
16	31303	O形密封圈 7 × 1.8	2	
17	31304	螺母 M10	1	
18	31305	档显线束	1	
19	31007	磁电机插盒	1	
20	31005	压线板	1	
21	31008	垫圈 8 × 23 × 3	1	
22	GB/T 70.1	内六角螺钉 M8 × 18	3	
23	31009	螺栓 M8 × 40	1	
24	GB/T 16674	螺栓 M6 × 28	2	
25	GB/T 818	螺钉 M4 × 10	2	
26	GB/T 5783	螺栓 M6 × 10	1	
27	31010	O形密封圈 13.8 × 2.5	1	
28	31011	O形密封圈 27.4 × 2.4	1	
29	31012	O形密封圈 63 × 3	1	
30	11018	左前盖纸垫	1	
31	31013	定位销 8 × 14	2	
32	GB/T 16674	螺栓 M6 × 25	5	
33	GB/T 16674	螺栓 M6 × 35	1	
34	GB/T 16674	螺栓 M6 × 40	1	
35	GB/T 16674	螺栓 M6 × 55	2	
36	GB/T 16674	螺栓 M6 × 60	1	
37	GB/T 16674	螺栓 M6 × 20	2	

E-8 曲轴箱体 Crankcase

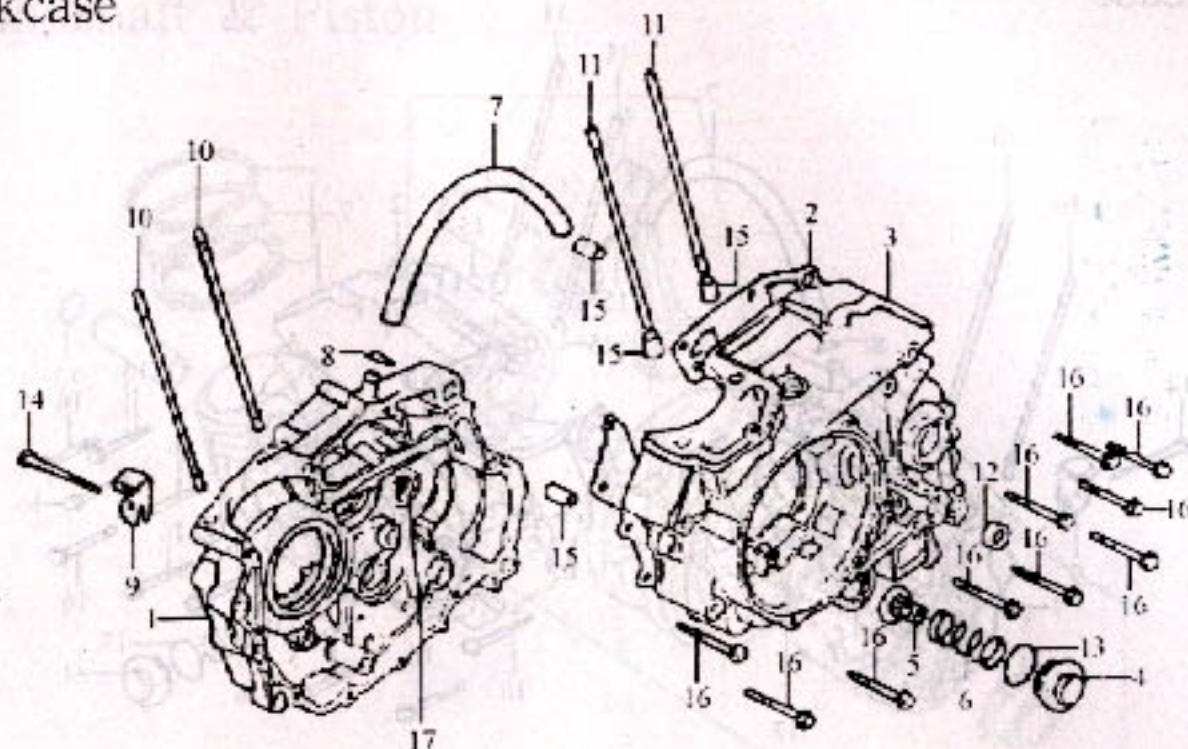

序号 Ref.No.	零部件代号 Part No.	零部件名称及规格	Part Name And Standard	数量 Quantity	备注 Remark
1	11200	右曲轴箱体	Right Piece	1	
2	11001	曲轴箱密封垫	Gasket	1	
3	11100	左曲轴箱体	Left Piece	1	
4	11025	机油滤网盖	Screw Cover	1	
5	11002	机油过滤网	Filter Net	1	
6	11003	固定弹簧	Spring	1	
7	11008	通气胶管	Air Pipe	1	
8	11007	管夹	Clamp	1	
9	11021	离合器拉筋定位板	Supporting Piece	1	
10	11005	气缸双头螺栓 (A)	Stud (A)	2	
11	11006	气缸双头螺栓 (B)	Stud (B)	2	
12	11015	油封 14 × 28 × 7	Oil Seal 14 × 28 × 7	1	
13	11026	O形密封圈 35 × 3	O-Ring 35 × 3	1	
14	GB 5787-86	螺栓 M6 × 55	Bolt M6 × 55	1	
15	11004	定位销 10 × 14	Locating Pin 10 × 14	4	
16	GB/T 16674	螺栓 M6 × 50	Bolt M6 × 50	10	
17	GB 290	滚针轴承	Bearing	1	

E-9 曲轴 & 活塞 Crankshaft & Piston

B-10 主副轴 Transmission Device

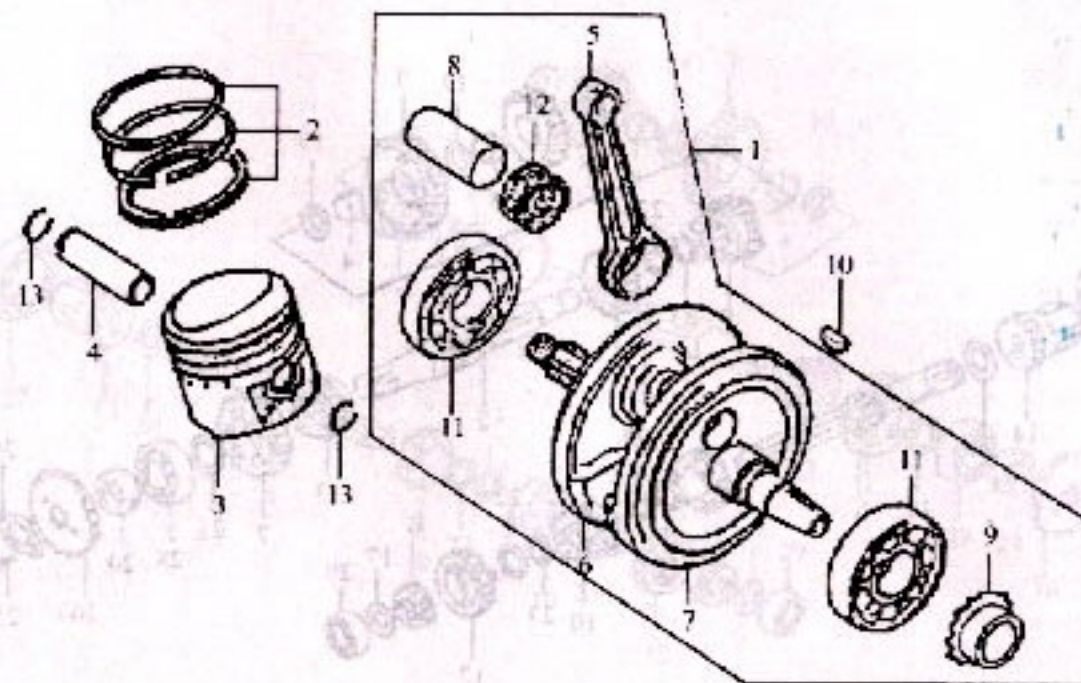

序号 Ref.No.	零部件代号 Part No.	零部件名称及规格	Part Name And Standard	数量 Quantity	备注 Remark
1	13100	曲柄连杆组件	Crankshaft Assy	1	
2	13200A	活塞环	Piston Ring Set	1	
3	13205	活塞	Piston	1	
4	13206	活塞销	Piston Pin	1	
5	13105	连杆	Conrod	1	
6	13103	右曲柄	Right Crankshaft	1	
7	13102	左曲柄	Left Crankshaft	1	
8	13104	曲轴销	Pin	1	
9	13106	正时主动齿轮	Timing Driving Gear	1	
10	13101	半圆键	Key	1	
11	13107	轴承	Bearing	2	
12	13108	滚针轴承	Roller Bearing	1	
13	13207	活塞销挡圈	Circlip	2	

E-10 主轴、副轴 Transmission Device

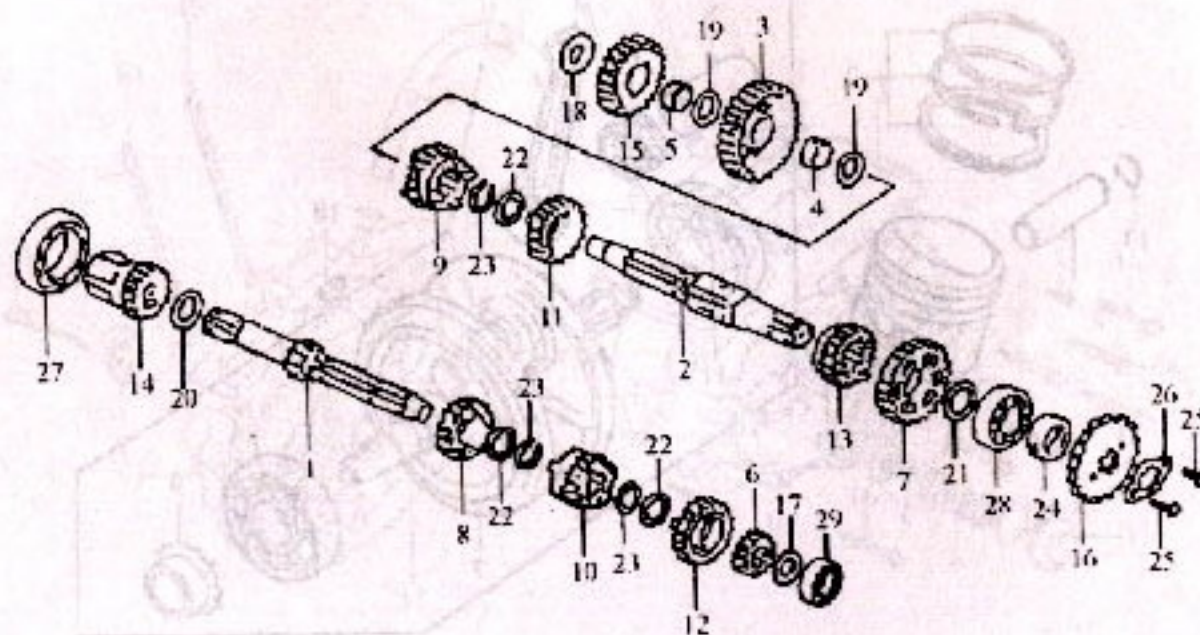

序号 Ref.No.	零部件代号 Part No.	零部件名称及规格	Part Name And Standard	数量 Quantity	备注 Remark
1	22101	传动主轴	Driving Shaft	1	
2	22201	传动副轴	Driven Shaft	1	
3	22203	1档从动齿轮	1st Driven Gear	1	
4	22208	轴套	Bush	1	
5	22209	轴套	Bush	1	
6	22104	2档主动齿轮	2nd Driving Gear	1	
7	22204	2档从动齿轮	2nd Driven Gear	1	
8	22105	3档主动齿轮	3rd Driving Gear	1	
9	22205	3档从动齿轮	3rd Driving Gear	1	
10	22106	4档主动齿轮	4nd Driving Gear	1	
11	22206	4档从动齿轮	4nd Driving Gear	1	
12	22107	5档主动齿轮	5nd Driving Gear	1	
13	22207	5档从动齿轮	5nd Driving Gear	1	
14	22108	启动组合齿轮	Starting Gear	1	
15	22210	启动过桥齿轮	Starting Gear	1	
16	22001	主动链轮	Driving Sprocket	1	
17	22109	推力垫圈	Dusk-Washer	1	
18	22211	推力垫圈	Dusk-Washer	1	
19	22212	推力垫圈	Dusk-Washer	2	
20	22110	推力垫圈	Dusk-Washer	1	
21	22213	垫圈	Washer	1	
22	22111	花键垫圈	Spine Washer	3	
23	22112	挡圈	Circlip	2	
24	22214	油封 20 × 34 × 7	Oil Seal 20 × 34 × 7	1	
25	GB/T 5783	螺栓 M6 × 10	Bolt M6 × 10	2	
26	22002	主动链轮定位板	Locating Plate	1	
27	GB 276	轴承 106	Bearing 106	1	
28	GB 276	轴承 202	Bearing 202	1	
29	GB 276	轴承 204	Bearing 204	1	

E-11 起动轴组件 Starting Shaft

Transmission Device 主机 01-3

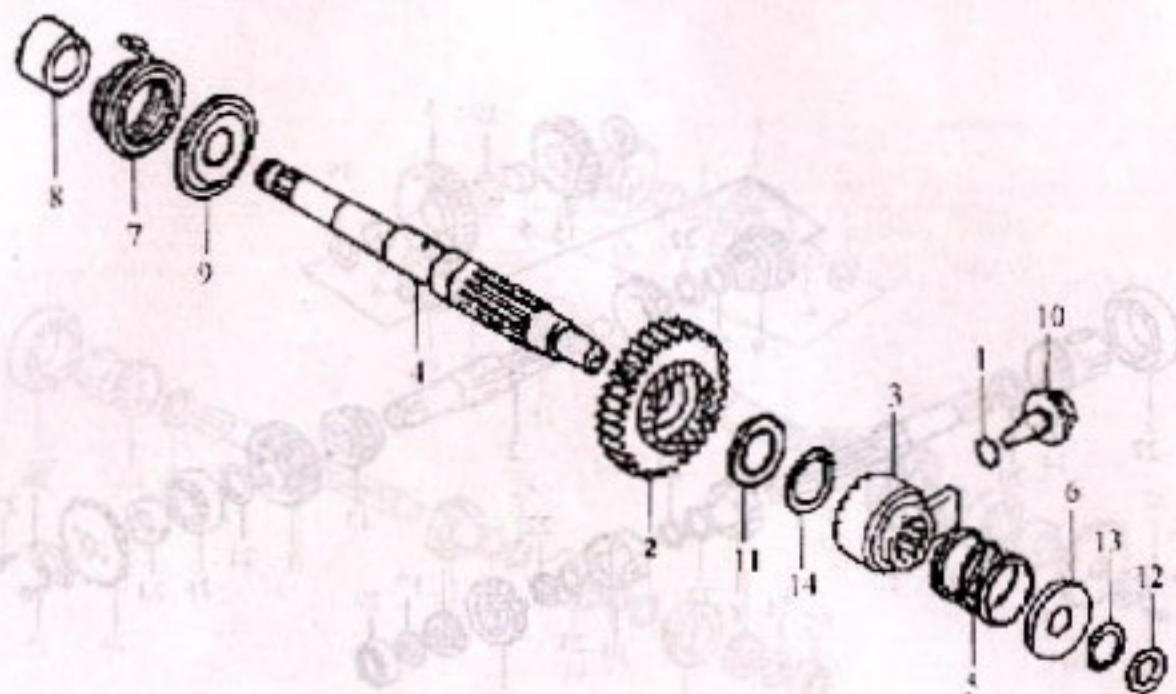

序号 Ref.No.	零部件代号 Part No.	零部件名称及规格	Part Name And Standard	数量 Quantity	备注 Remark
1	GB 3452.1	O形密封圈 11.8 × 2.65	O-Ring 11.8 × 2.65	1	
2	24101	起动齿轮	Starting Shaft	1	
3	24104	起动棘轮	Ratchet Gear	1	
4	24110	启动轴	Starting Shaft	1	
5	24105	棘轮弹簧	Ratchet Spring	1	
6	24111	导板	Guide Piece	1	
7	24109	回位弹簧	Reset Spring	1	
8	24114	弹簧内套	Spring Sleeve	1	
9	24108	弹簧座	Spring Seat	1	
10	24116	定位螺栓	Locating Bolt	1	
11	24102	推力垫圈	Washer	1	
12	24106	推力垫圈	Washer	1	
13	GB 894.1	挡圈 16	Circlip 16	1	
14	24113	弹簧挡圈	Circlip	1	

E-12 变速机构 Drum Set

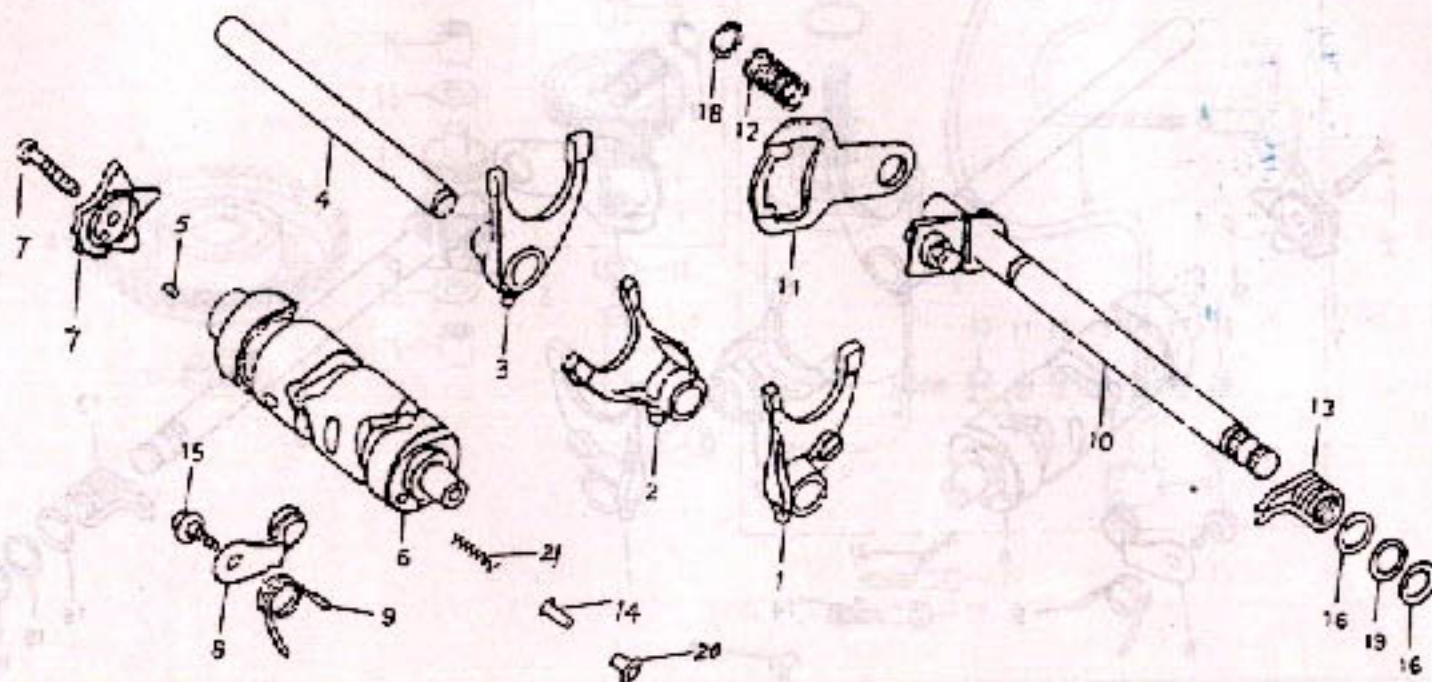

序号 Ref.No.	零部件代号 Part No.	零部件名称及规格	Part Name And Standard	数量 Quantity	备注 Remark
1	23102	拨叉 I	Controlling Piece I	1	
2	23103	拨叉 II	Controlling Piece II	1	
3	23104	拨叉 III	Controlling Piece III	1	
4	23105	拨叉轴	Shaft	1	
5	GB/T 119.1	定位销 B4 × 10	Pin B4 × 10	1	
6	23101	变速鼓	Drum	1	
7	23002	拨板	Controlling Piece	1	
8	23300	定位板组合	Limit Part	1	
9	23001	复位弹簧	Reset Spring	1	
10	23200	变速轴组件	Shaft	1	
11	23201	活动拨板	Controlling Block	1	
12	23202	压簧	Spring	1	
13	23203	复位弹簧	Spring	1	
14	23106	档显触点	Conceding Piece	1	
15	GB5783-86	螺栓 M6 × 20	Bolt M6 × 20	1	
16	23108	推力垫圈	Washer	2	
17	GB/T 5783	螺栓 M6 × 25	Bolt M6 × 25	1	
18	GB 894.1	挡圈 12	Circllet 12	1	
19	GB 894.1	挡圈 14	Circllet 14	1	

E-14 化油器 Carburetor

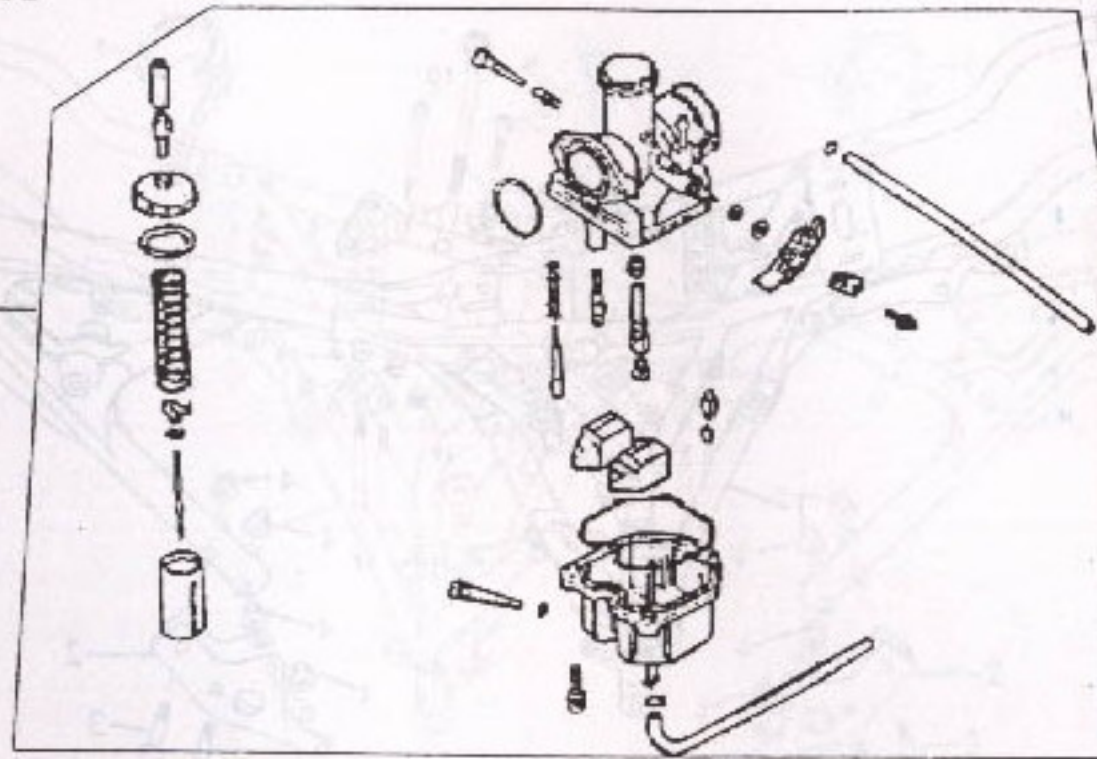

序号 Ref.No.	零部件代号 Part No.	零部件名称及规格	Part Name And Standard	数量 Quantity	备注 Remark
1	33100	化油器总成	Carburator Assy	1	
2		上盖	Upper Cover	1	
3		浮子针	Float Needle	1	
4		浮子针簧	Float Needle Spring	1	
5		浮子	Float	1	
6		浮子轴	Float Pin	1	
7		浮子轴套	Float Pin Sleeve	1	
8		浮子轴簧	Float Pin Spring	1	
9		浮子轴衬套	Float Pin Bush	1	
10		浮子轴衬套	Float Pin Bush	1	
11		浮子轴衬套	Float Pin Bush	1	
12		浮子轴衬套	Float Pin Bush	1	
13		浮子轴衬套	Float Pin Bush	1	
14		浮子轴衬套	Float Pin Bush	1	

F-1 Frame 车架

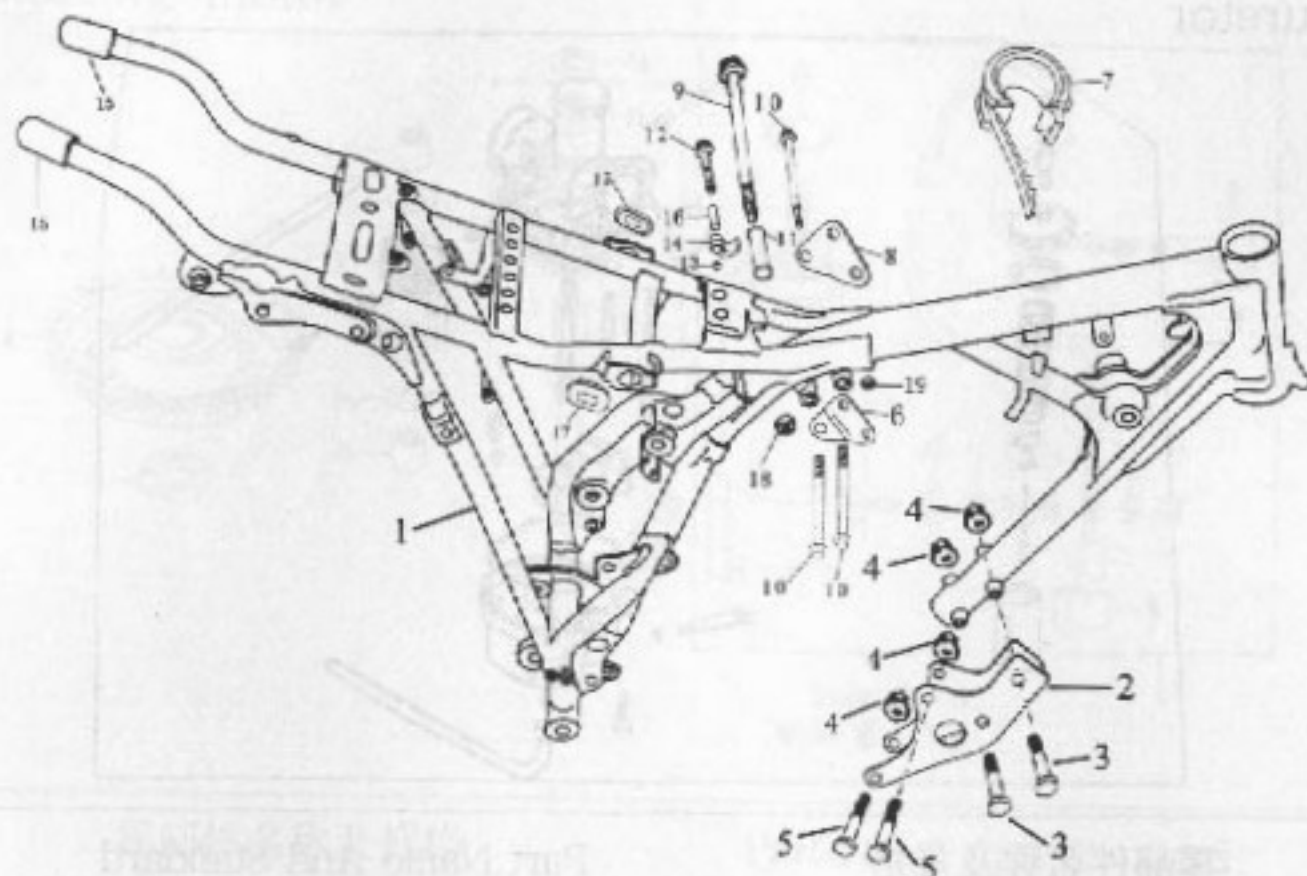

序号 Ref.No.	零部件代号 Part No.	零部件名称及规格	Part Name And Standard	数量 Quantity	备注 Remark
1	VYP(M)000-111000	车架	Frame	1	
2	VYP(M)000-738000	发动机前托架	Front bracket	1	
3	GB5787	发动机前悬挂螺栓 M8 × 75	Bolt M8 × 75	2	
4	GB6187	螺母 M8	Nut M8	4	
5	GB5787	发动机前悬挂螺栓 M8 × 90	Bolt M8 × 90	2	
6	VYP(M)000-111005	发动机上右悬挂板	Upper R. append plank,engine	1	
7	VYP(M)000-780005	油箱 U 型胶	"U" rubber of fuel tank	1	
8	VYP(M)000-111002	发动机上左悬挂板	Upper L. append plank,engine	1	
9	GB5782	发动机前悬挂螺栓 M10 × 165	Bolt M10 × 165	1	
10	GB5782	发动机上悬挂螺栓	Bolt	3	
11	VYP(M)000-111001	衬管	Bush	1	
12	GB5787	螺栓 M6 × 35	Bolt M6 × 35	1	
13	GB6170	螺母 M6	Nut M6	1	
14	VYP(M)000-111003	链条上护卡	Protect clip	1	

15	VYP(M)000-111004	车架尾管胶	Rubber	2	
16	VYP(M)000-111006	链条上护卡衬套	Bush	1	
17	VYP(M)000-780013	工字胶	Damping rubber	2	
18	GB6177	螺母 M10	Nut M10	1	
19	GB6187	螺母 M8	Nut M8	3	

F-2 Front cover 前面板

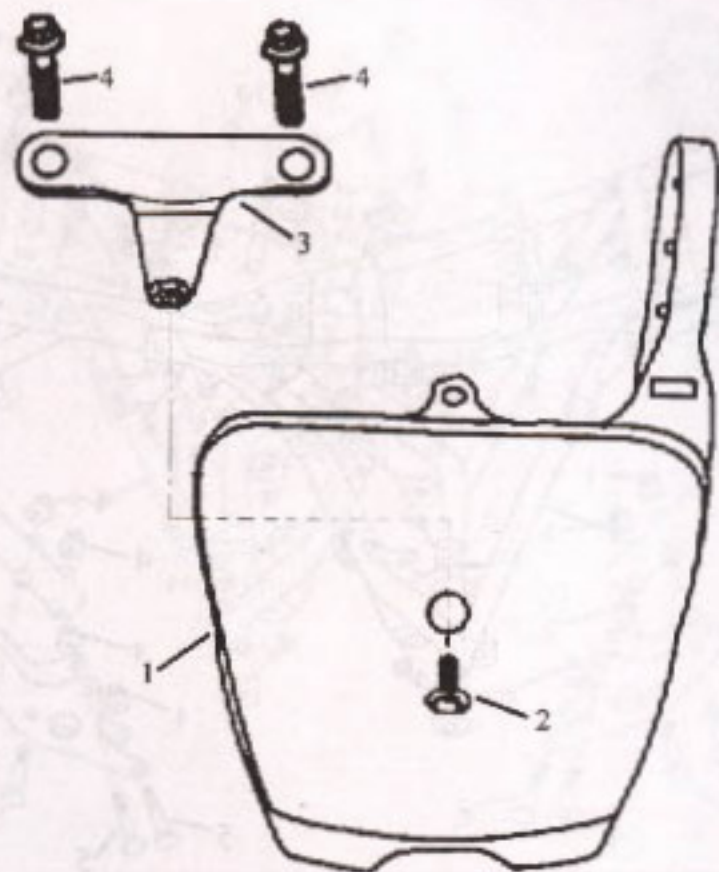

序号 Ref.No.	零部件代号 Part No.	零部件名称及规格	Part Name And Standard	数量 Quantity	备注 Remark
1	VYPM000-416000	前面板	Front cover	1	
2	GB5787	螺栓 M6 × 16	Bolt M6 × 16	1	
3	VYPM000-703001	前面板上支架	Upper Stand, Front cover	1	
4	GB5787	螺栓 M6 × 12	Bolt M6 × 12	2	

F-3 Front Fender 前挡泥板

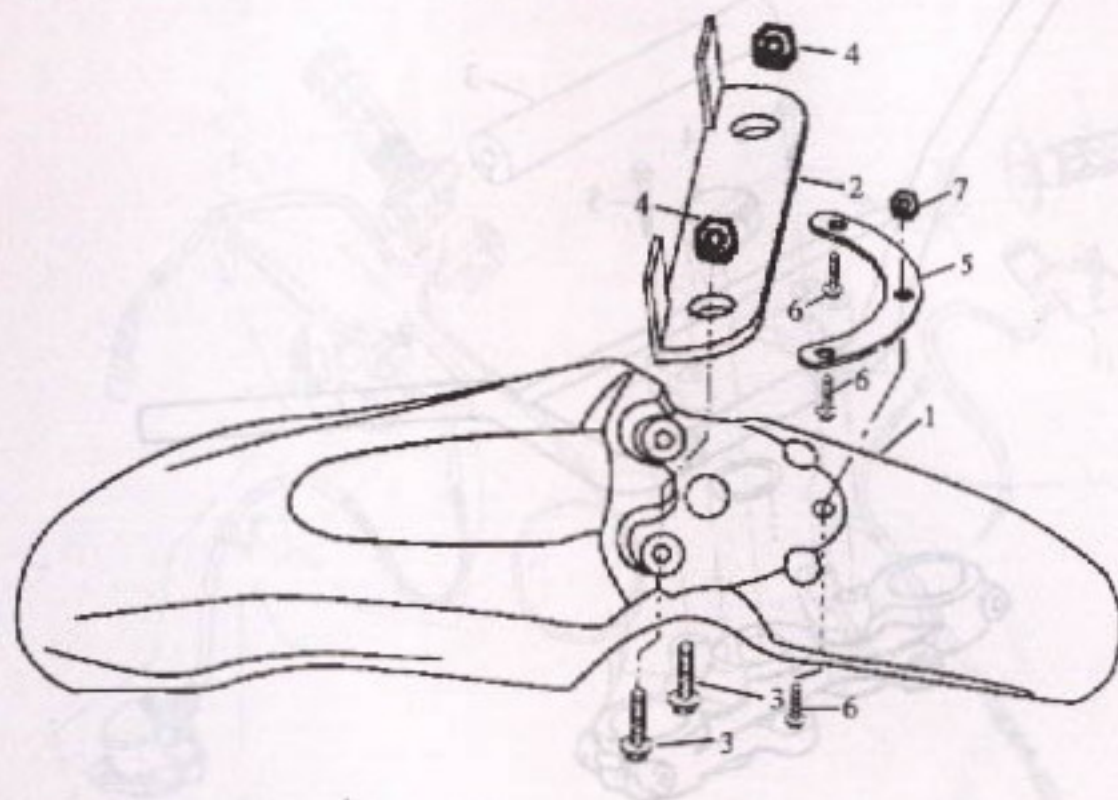

序号 Ref.No.	零部件代号 Part No.	零部件名称及规格	Part Name And Standard	数量 Quantity	备注 Remark
1	VYP(M)000-401001	前挡泥板	Front Fender	1	
2	VYP(M)000-401003	前面板下支架	Down stand, front cover	1	
3	GB5787	螺栓 M6 × 30	Bolt M6 × 30	2	
4	GB6177	螺母 M6	Nut M6	2	
5	VYP(M)000-401002	前挡泥板支架	Stand, front fender	1	
6	GB5787	螺栓 M6 × 12	Bolt M6 × 12	3	
7	GB6177	螺母 M6	Nut M6	1	

F-4 Handlebar 手把管

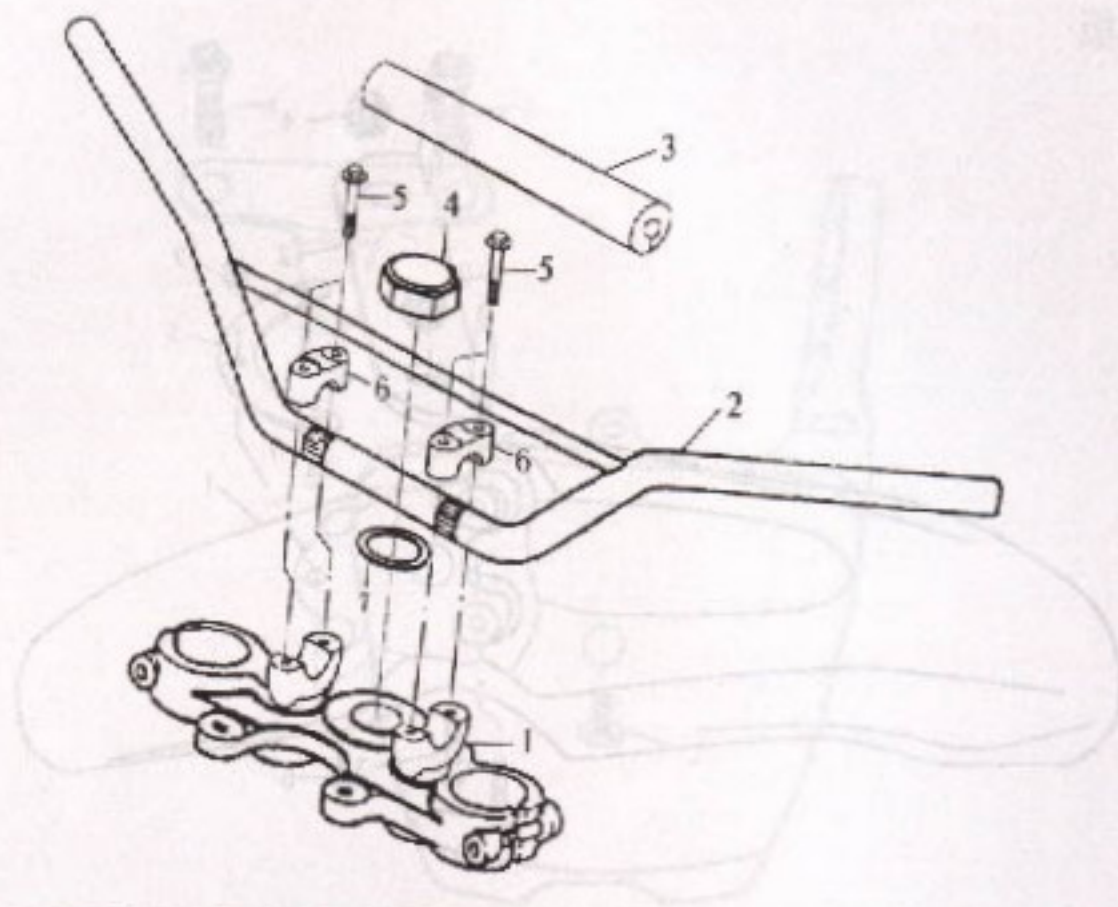

序号 Ref.No.	零部件代号 Part No.	零部件名称及规格	Part Name And Standard	数量 Quantity	备注 Remark
1	VYP(M)000-313001	方向柱上联接板组合	Upper connect panel comp	1	
2	VYP(M)000-311000	手把管	Handlebar pipe	1	
3	VYP(M)000-313003	手把装饰罩	Handlebar cover	1	
4	VYP(M)000-313005	盖形螺母	Nut	1	
5	GB5787	螺栓 M8 × 35	Bolt M8 × 35	4	
6	VYP(M)000-313002	手把管卡子	Upper fastener	2	
7	VYP(M)000-313006	垫圈	Washer	1	

F-5 Brake Handle Grip, Switch, Front Brake 手把胶、开关、前制动

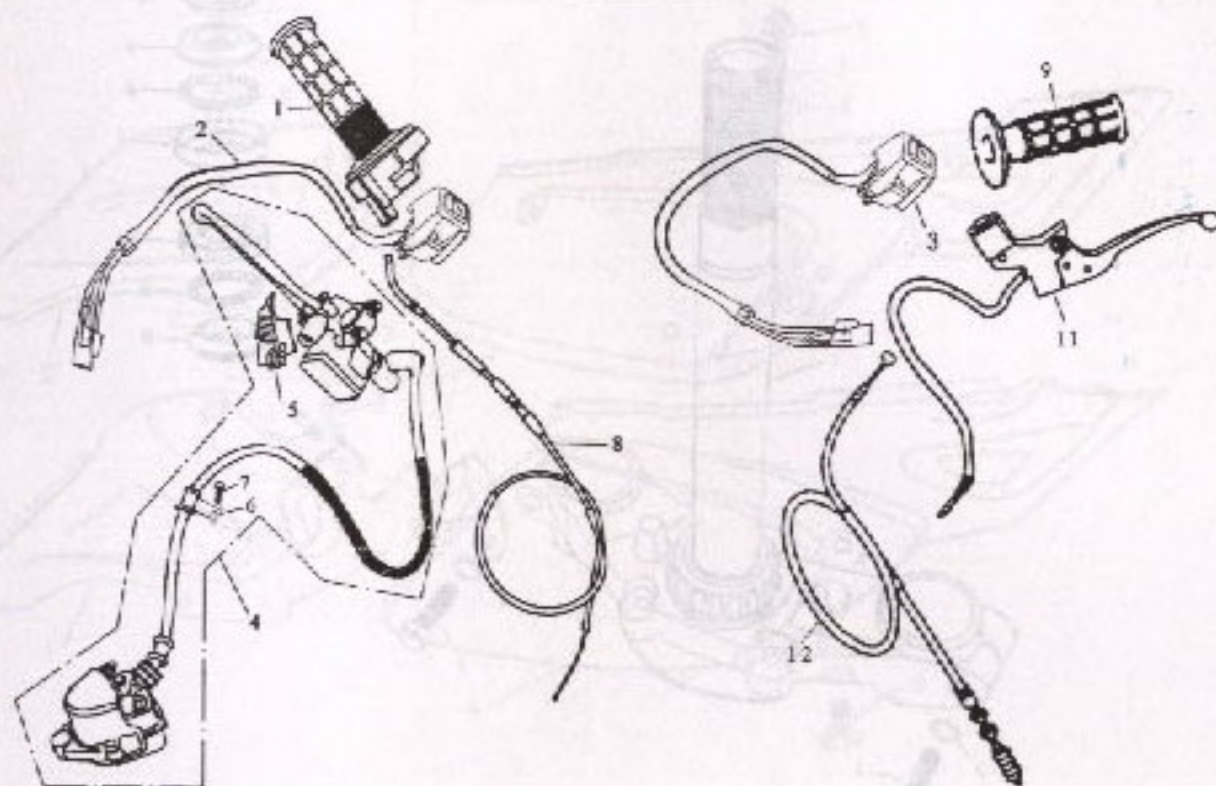

序号 Ref.No.	零部件代号 Part No.	零部件名称及规格	Part Name And Standard	数量 Quantity	备注 Remark
1	VYP(M)000-791000	右手把胶	Right grip	1	
2	VYP(M)000-565000	电起动开关	Starting switch	1	
3	VYP(M)000-566000	熄火开关	Flameout switch	1	
4	VYP(M)000-332200	碟刹总成	Hydraulic pressure brake assy	1	
5	VYP(M)000-332201	碟刹手柄护套	Handle lever jacket	1	
6	VYP(M)000-332202	碟刹管固定支架	Stand	1	
7	GB5787	螺钉 M6 × 12	Screw M6 × 12	1	
8	VYP(M)000-321002	油门线	Throttle cable	1	
9	VYP(M)000-790001	左手把胶	Left grip	1	
10	VYP(M)000-566000	熄火开关	Flameout switch assy	1	
11	VYP(M)000-312200	左手柄组件	Left handle lever	1	
12	VYP(M)000-324000	离合线	Clutch cable	1	

F-6 Steering stem 方向柱

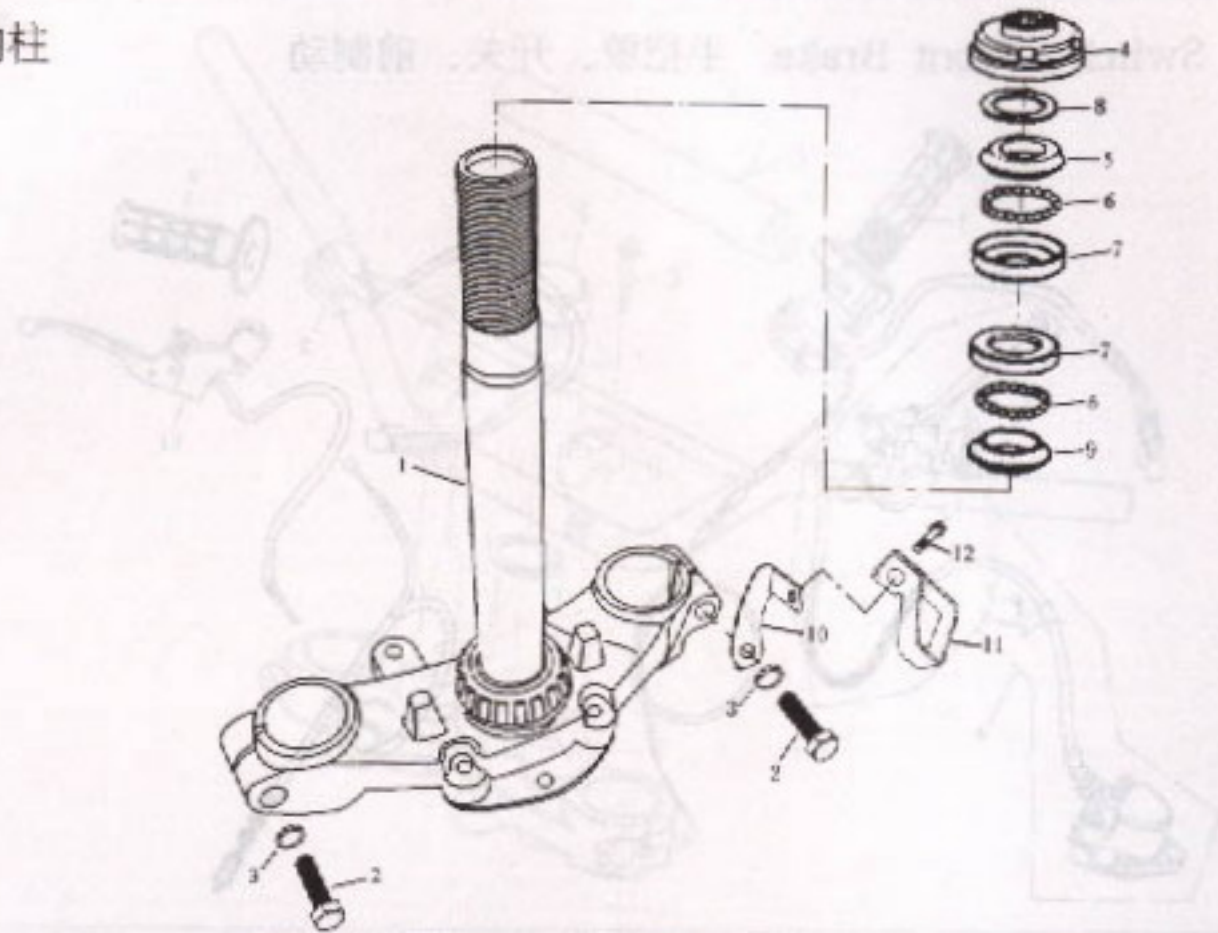

序号 Ref.No.	零部件代号 Part No.	零部件名称及规格	Part Name And Standard	数量 Quantity	备注 Remark
1	VYP(M)000-313000	方向柱组件	Steering stem	1	
2	GB5783	螺栓 M10 × 40	Bolt M10 × 40	2	
3	GB93	弹垫 10	Spring washer 10	2	
4	VYP(M)000-313001	调整螺母组合	Adjusting nut comp	1	
5	VYP(M)000-313201	轴承上挡圈	Race outer upper	1	
6	VYP(M)000-313205	方向柱轴承组件	Bearing	2	
7	VYP(M)000-313203	轴承座圈	Race inner	2	
8	VYP(M)000-313002	垫圈	Washer	1	
9	VYP(M)000-313202	轴承下挡圈	Race outer lower	1	
10	VYP(M)000-313001	碟刹管支架	Stand	1	
11	VYP(M)000-313004	碟刹管护套	Jacket, brake hose	1	
12	GB5787	螺栓 M6 × 12	Bolt M6 × 12	1	

F-7 Side cover 侧盖

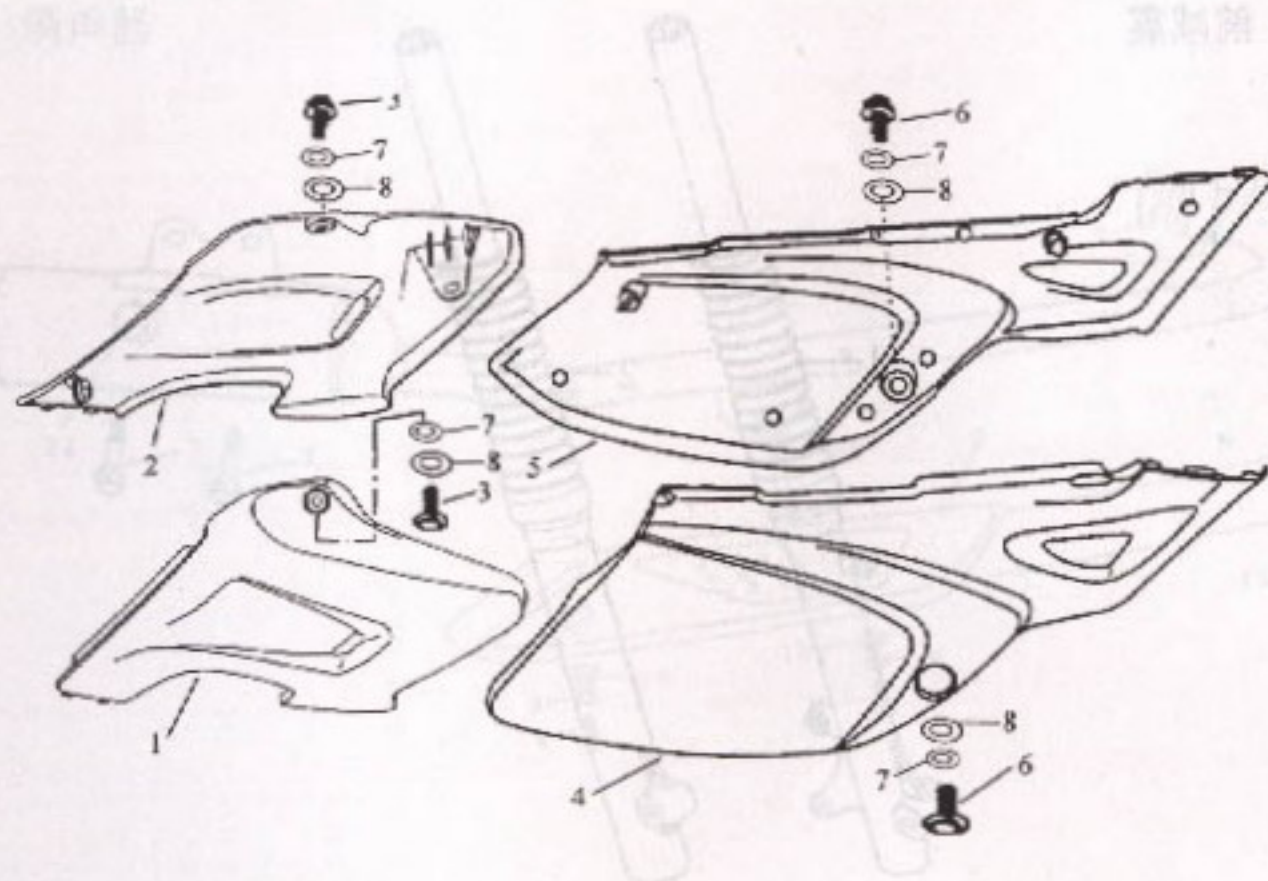

序号 Ref.No.	零部件代号 Part No.	零部件名称及规格	Part Name And Standard	数量 Quantity	备注 Remark
1	VYP(M)000-429003	油箱左装饰罩	L. cover, fuel tank	1	
2	VYP(M)000-428003	油箱右装饰罩	R. cover, fuel tank	1	
3	VYP(M)000-131900	十字大扁头螺钉 M6 × 12	Screw M6 × 12	2	
4	VYP(M)000-405002	左侧盖	L. side cover	1	
5	VYP(M)000-406002	右侧盖	R. side cover	1	
6	VYP(M)000-131800	十字大扁头螺钉 M6 × 16	Screw M6 × 16	2	
7	GB96	垫圈 6	Washer 6	4	
8	GB96	胶垫圈 6	Rubber washer 6	4	

F-8 Front shock absorber 前减震

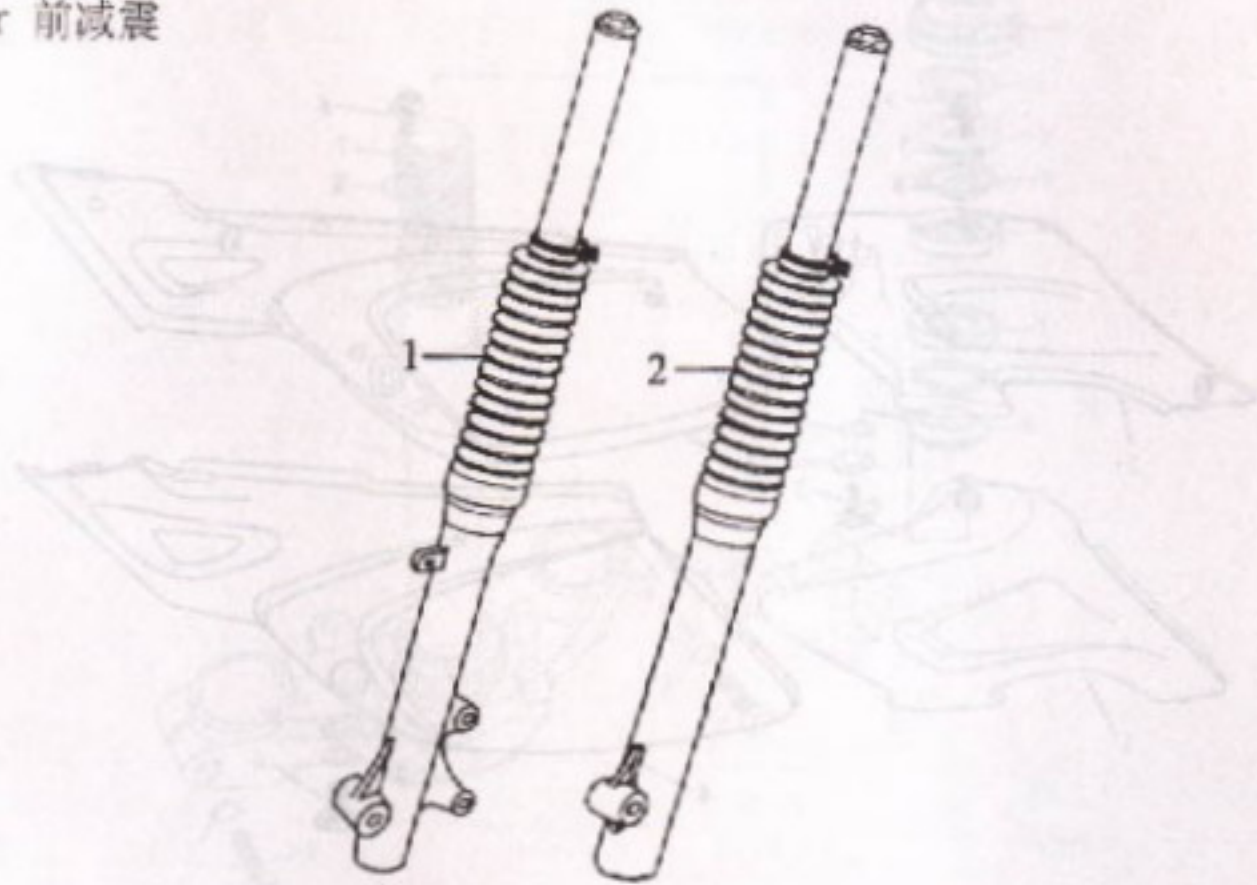

序号 Ref.No.	零部件代号 Part No.	零部件名称及规格	Part Name And Standard	数量 Quantity	备注 Remark
1	VYPM000-152100	前左减震器	Front L. shock absorber	1	
2	VYPM000-152200	前右减震器	Front R. shock absorber	1	
3					
4					
5					
6					
7					
8					
9					
10					
11					
12					

F-9 Exhaust Muffler 消声器

图号: 701.11A.01-2

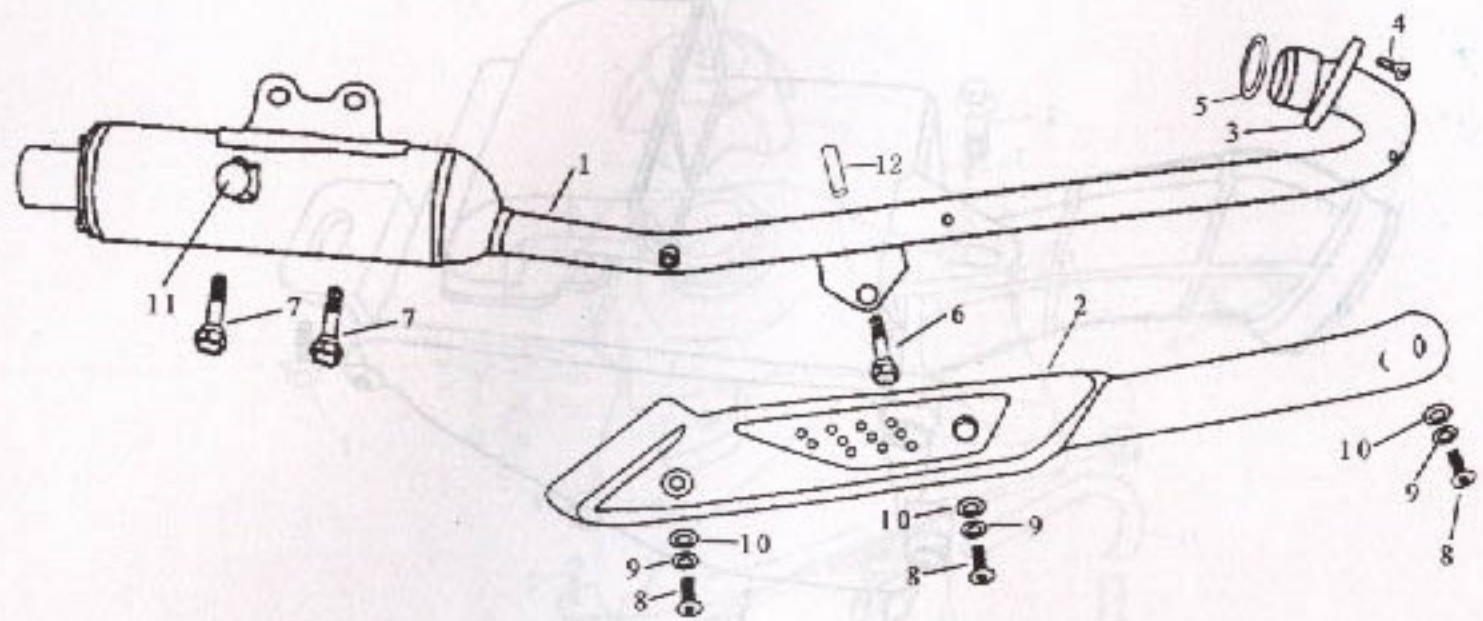

序号 Ref.No.	零部件代号 Part No.	零部件名称及规格	Part Name And Standard	数量 Quantity	备注 Remark
1	VYP(M)000-073500	消声器组件	Exhaust muffler assy	1	
2	VYP(M)000-074000	消声器护罩	Protect cover	1	
3	VYP(M)000-073801	消声器连接块	Joint piece	1	
4	GB5787	螺栓 M6 × 20	Bolt M6 × 20	2	
5	VYP(M)000-073501	消声器密封垫	Gasket	1	
6	GB5787	螺栓 M8 × 20	Bolt M8 × 20	1	
7	GB5787	螺栓 M8 × 20	Bolt M8 × 20	2	
8	GB818	螺钉 M6 × 12	Screw M6 × 12	3	
9	GB93	弹垫 6	Spring washer 6	3	
10	GB97.1	平垫 φ6	Washer 6	3	
11	VYP(M)000-073001	消声器减震胶垫	Rubber	1	
12	VYP(M)000-073502	衬套	Bush	1	

F-10 Air Filter 空滤器

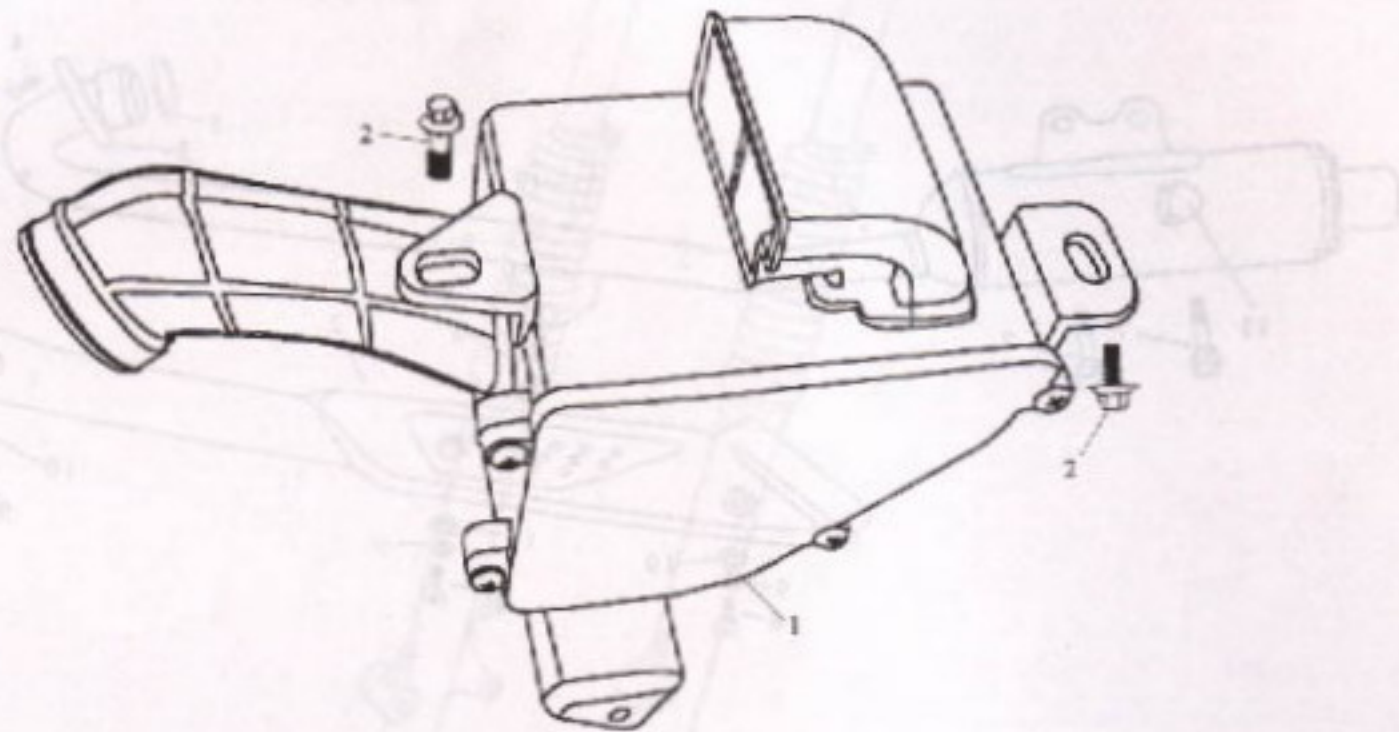

序号 Ref.No.	零部件代号 Part No.	零部件名称及规格	Part Name And Standard	数量 Quantity	备注 Remark
1	VYP(M)000-071000	空滤器组件	Air filter assy	1	
2	GB5787	螺栓 M6 × 16	Bolt M6 × 16	2	

F-11 Fuel Tank 油箱

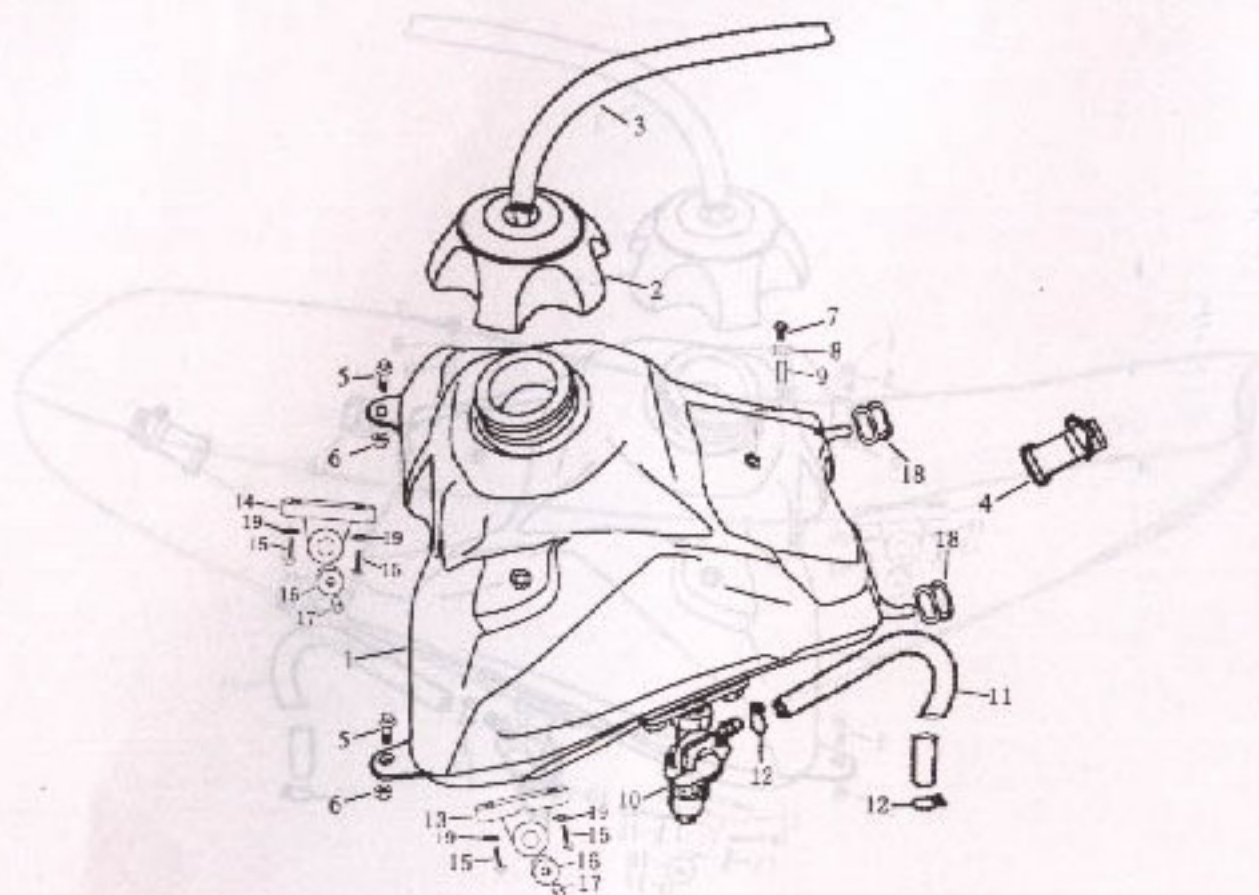

序号 Ref.No.	零部件代号 Part No.	零部件名称及规格	Part Name And Standard	数量 Quantity	备注 Remark
1	VYP(M)000-131000	油箱	Fuel Tank	1	
2	VYP(M)000-131100	油箱盖	Fuel Tank cover	1	
3	VYP(M)000-131200	油箱盖通气管	Hose	1	
4	VYP(M)000-131300	油箱拉带	Band	1	
5	GB5787	螺栓 M6 × 40	Bolt M6 × 40	2	
6	GB5787	螺母 M6	Nut M6	2	
7	GB819	螺钉 M6 × 12	Bolt M6 × 12	1	
8	VYP(M)000-131600	大平垫 6	Washer 6	1	
9	VYP(M)000-131301	衬管	Tube	1	
10	VYP(M)000-132000	油开关	Fuel cock	1	
11	VYP(M)000-121003	燃油管	Hose	1	
12	VYP(M)000-121004	油管夹	Clip	2	
13	VYP(M)000-131400	油箱左固定座	Fixing seat	1	
14	VYP(M)000-131500	油箱右固定座	Fixing seat	1	
15	GB5783	螺栓 M6 × 12	Bolt M6 × 12	4	
16	VYP(M)000-131700	工字胶	I-shaped Rubber	2	
17	VYP(M)000-131302	衬管	Tube	2	
18	VYP(M)000-780007	侧盖减震胶	Damping rubber	2	
19	GB97	垫圈 6	Washer 6	4	

F-13 Front Wheel 前轮

图号 J68 01-7

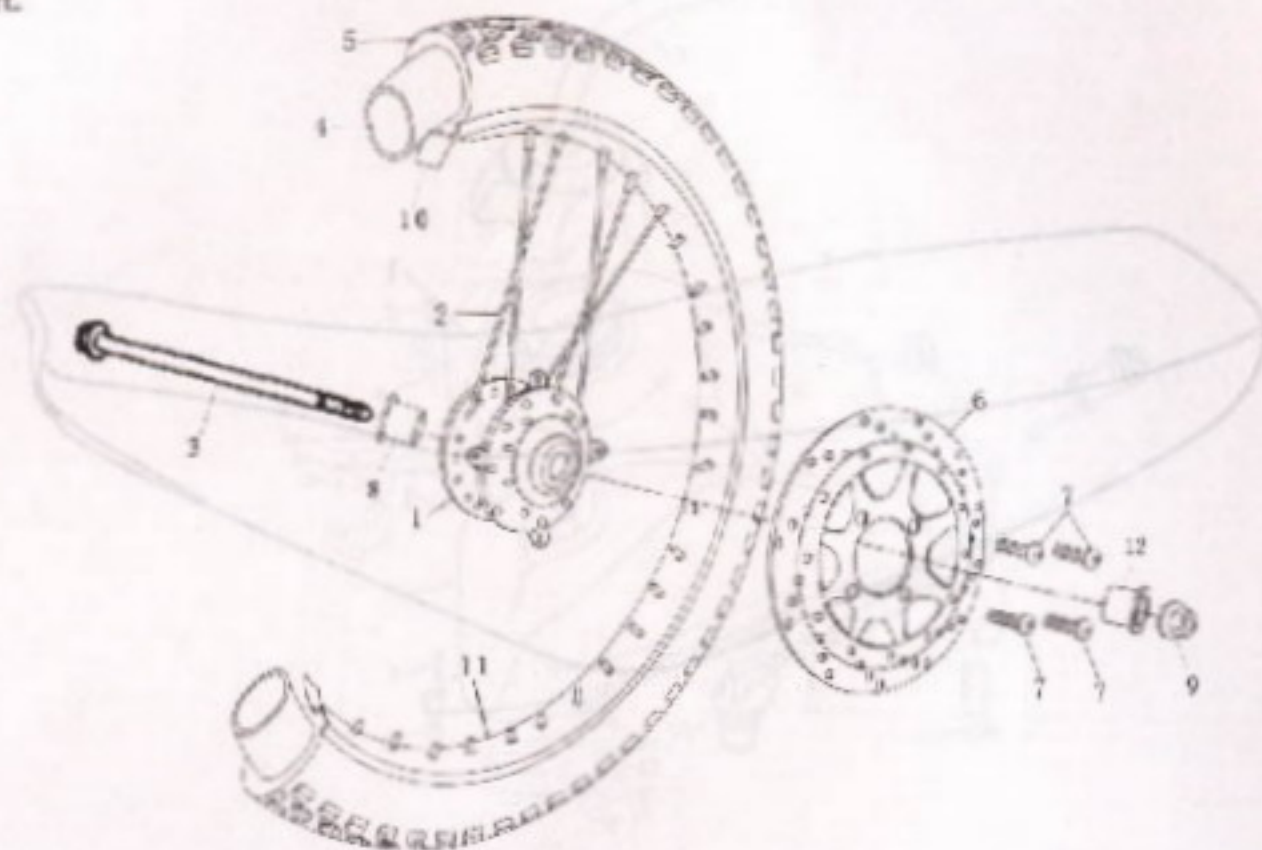

序号 Ref.No.	零部件代号 Part No.	零部件名称及规格	Part Name And Standard	数量 Quantity	备注 Remark
1	VYPM000-170200	前轮毂	Front hub	1	
2	VYPM000-170300	前轮辐条组件	Front spoke assy	1	
3	VYPM000-191001	前轮轴	Front axle	1	
4	VYPM000-170500	前轮内胎	Front tube	1	
5	VYPM000-170400	前轮外胎	Front tyre	1	
6	VYPM000-330100	碟刹盘	Brake disk	1	
7	VYPM000-330101	碟刹盘安装螺钉 (内六角台阶螺栓) M6 × 11	Screw M6 × 11	4	
8	VYPM000-192001	前轮右衬套	Bush	1	
9	GB6178	螺母 M12	Nut M12	1	
10	VYPM000-170510	垫带	Cushion webbing	1	
11	VYPM000-170600	前轮圈	Front rim	1	
12	VYPM000-192002	前轮左衬套	Bush	1	

F-14 Rear Wheel 后轮

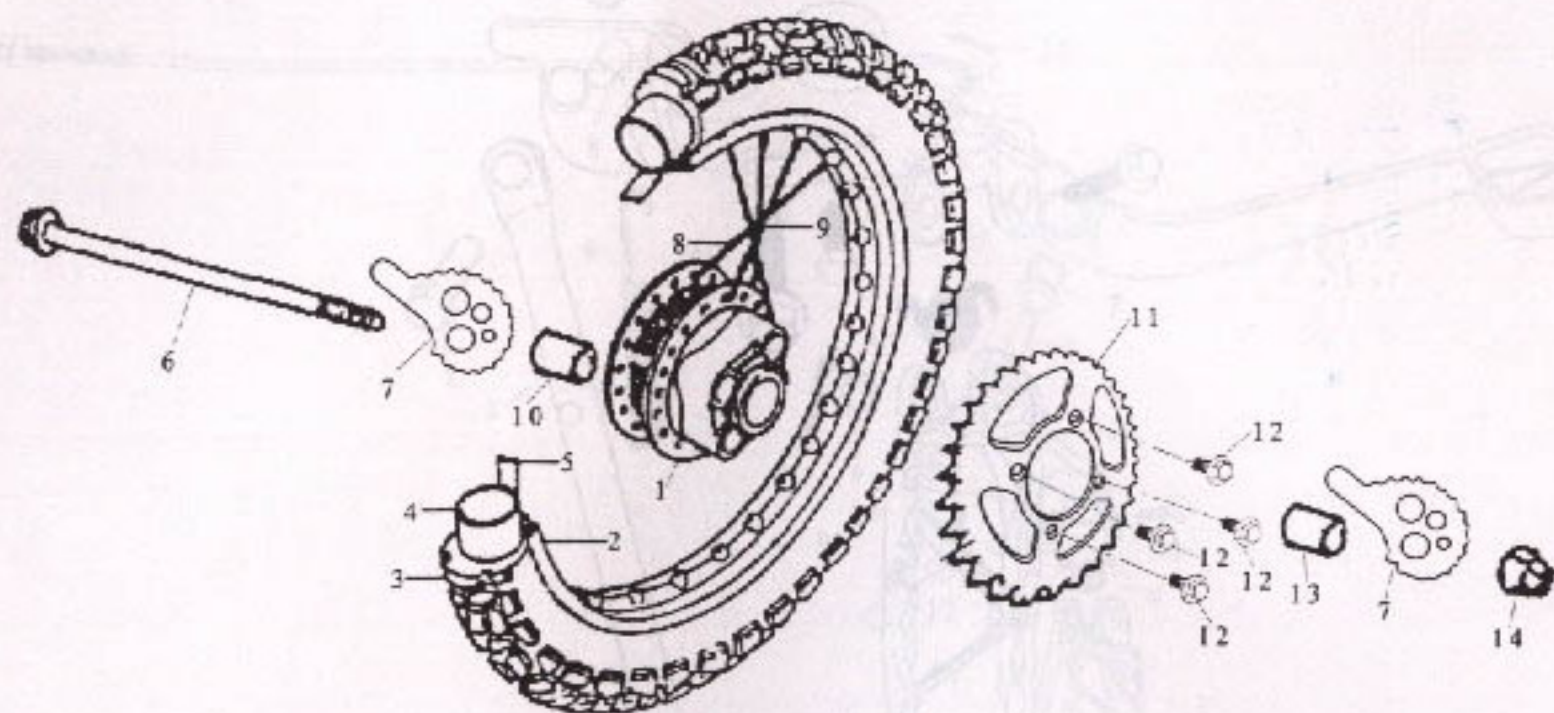

序号 Ref.No.	零部件代号 Part No.	零部件名称及规格	Part Name And Standard	数量 Quantity	备注 Remark
1	VYP(M)000-180200	后轮毂	Rear hub	1	
2	VYP(M)000-180100	后轮辋	Rear rim	1	
3	VYP(M)000-180400	后轮外胎	Rear tyre	1	
4	VYP(M)000-180510	后轮内胎	Rear tube	1	
5	VYP(M)000-180500	垫带	Cushion webbing	1	
6	VYP(M)000-191002	后轮轴 M12 × 220	Rear axle	1	
7	VYP(M)000-183005	链轮止退片	Sprocket stop piece	2	
8	VYP(M)000-180301	后轮内侧辐条	Inner spoke	1	
9	VYP(M)000-180302	后轮外侧辐条	Outer spoke	1	
10	VYP(M)000-192007	后轮右衬套	R. bush, rear wheel	1	
11	VYP(M)000-214001	链轮	sprocket	1	
12	GB5783	螺栓 M10 × 30	Bolt M10 × 30	4	
13	VYP(M)000-192006	后轮左衬套	L. bush, rear wheel	1	
14	GB6187	螺母 M12	Nut M12	1	

F-15 Side stand and L. footrest 侧支架及左搁脚

F-15 Side Stand and L. Footrest

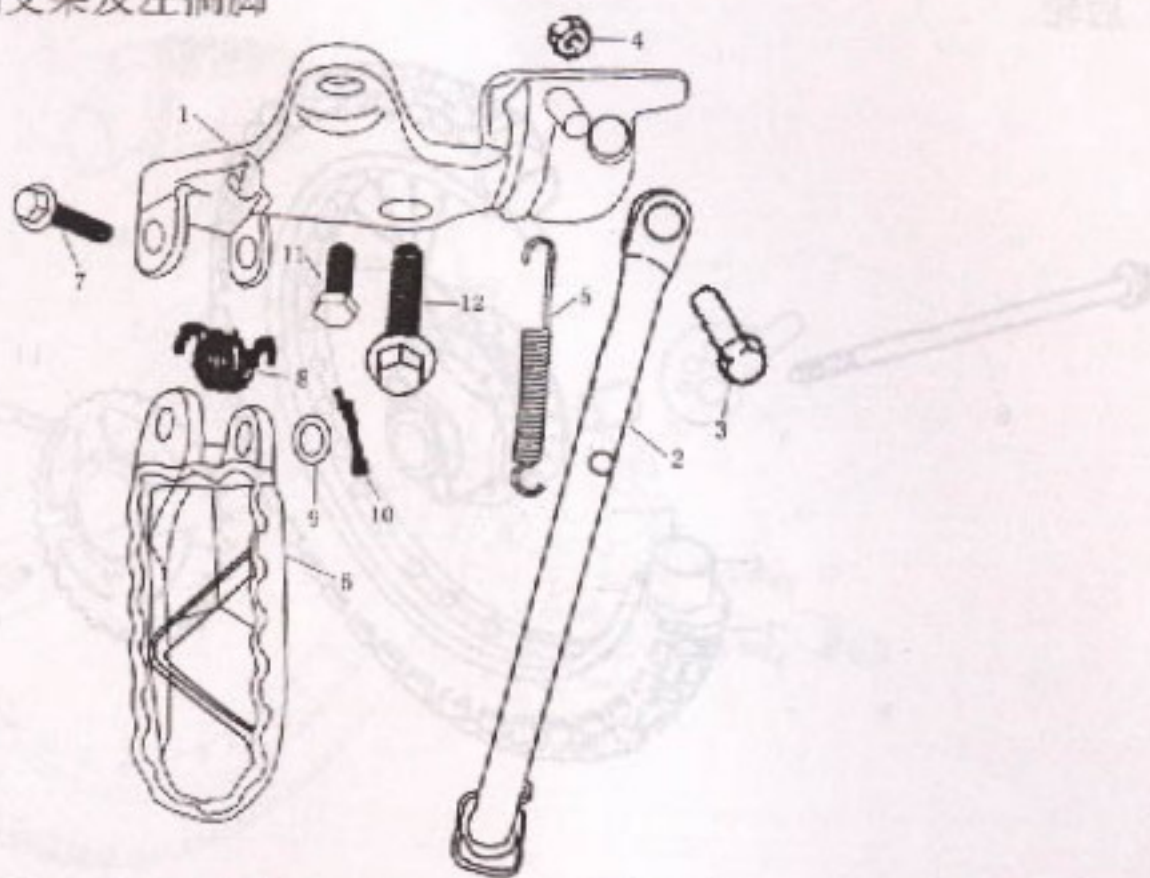

序号 Ref.No.	零部件代号 Part No.	零部件名称及规格	Part Name And Standard	数量 Quantity	备注 Remark
1	VYP(M)000-602002	左搁脚支架	Stand, L. footrest	1	
2	VYP(M)000-602000	侧支架	Side stand	1	
3	VYP(M)000-602001	销轴	Pin	1	
4	GB6170	螺母 M10	Nut M10	1	
5	VYP(M)000-600002	侧支架挂簧	Spring	1	
6	VYP(M)000-603100	左搁脚	L. footrest	1	
7	GB882	左搁脚定位销	Fixing pin, L. footrest	1	
8	VYP(M)000-600005	搁脚回位弹簧	R. step spring	1	
9	GB97	平垫 6	Washer 6	1	
10	GB91	开口销 2 × 20	Pin 2 × 20	1	
11	GB5789	螺栓 M10 × 20	Bolt M10 × 20	1	
12	GB5783	螺栓 M10 × 25	Bolt M10 × 25	1	

F-16 Brake pedal and R. footrest 制动踏板及右搁脚

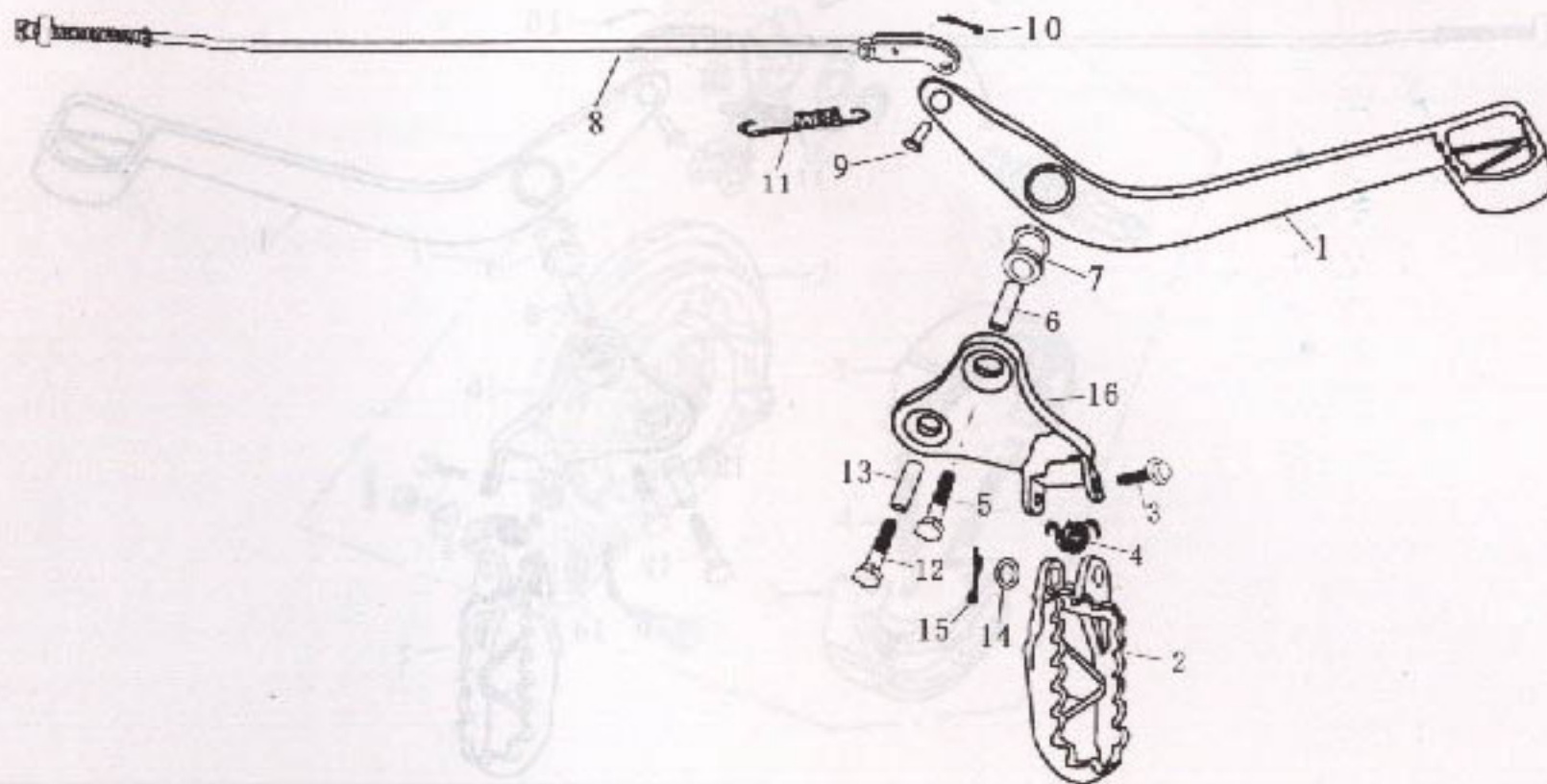

序号 Ref.No.	零部件代号 Part No.	零部件名称及规格	Part Name And Standard	数量 Quantity	备注 Remark
1	VYP(M)000-318000	后制动踏板	Rear brake pedal	1	
2	VYP(M)000-603200	右搁脚	R. footrest	1	
3	GB882	右搁脚定位销	Fixing pin, R. footrest	1	
4	VYP(M)000-603201	搁脚回位弹簧	R. Step spring	1	
5	GB5789	螺栓 M10 × 1.25 × 35	Bolt M10 × 1.25 × 35	1	
6	VYP(M)000-603202	后制动踏板内衬套 φ 10 × φ 17 × 28	Tube φ 10 × φ 17 × 28	1	
7	VYP(M)000-318001	后制动踏板衬套 φ 10 × φ 22 × 9	Bush φ 10 × φ 22 × 9	1	
8	VYP(M)000-318003	后制动拉杆组件	Rear brake rod assy	1	
9	VYP(M)000-318004	锁轴	Pin	1	
10	GB91	开口销 2 × 20	Pin 2 × 20	1	
11	VYP(M)000-318002	拉簧	Spring	1	
12	GB5789	螺栓 M10 × 1.25 × 60	Bolt M10 × 1.25 × 60	1	
13	VYP(M)000-603203	右主搁脚支架衬套 φ 10 × φ 22 × 9	Bush φ 10 × φ 22 × 9	1	
14	GB97	平垫 6	Washer 6	1	
15	GB91	开口销 2X20	Pin 2 X 20	1	
16	VYP(M)000-603204	右主搁脚支架	Stand, R. Footrest	1	

F-17 Rear brake 后制动器

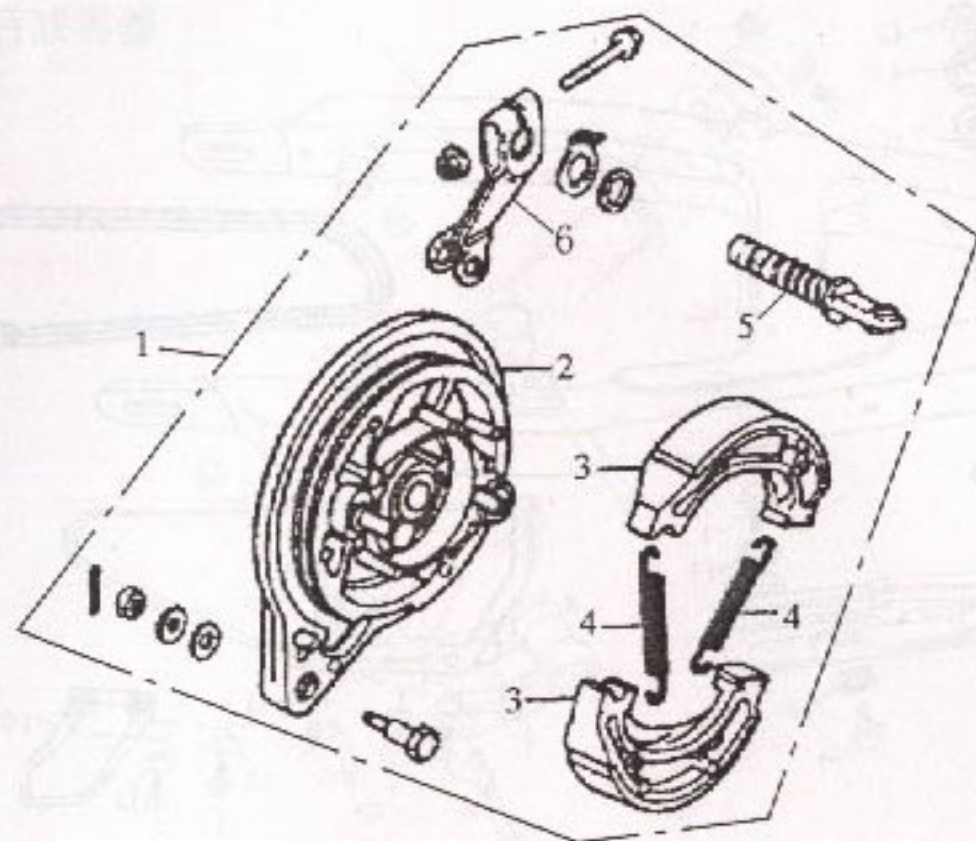

序号 Ref.No.	零部件代号 Part No.	零部件名称及规格	Part Name And Standard	数量 Quantity	备注 Remark
1	VYP(M)000-333000	后制动器总成	Rear brake assy	1	
2	VYP(M)000-333001	后制动器盖	Rear brake cover	1	
3	VYP(M)000-333002	后制动蹄块组件	Rear brake shoe assy	2	
4	VYP(M)000-333003	后制动拉簧	Rear brake spring	2	
5	VYP(M)000-333004	后制动凸轮	Rear brake cam	1	
6	VYP(M)000-333005	后制动器摇臂	Arm, rear brake	1	

F-18 Fork 平叉

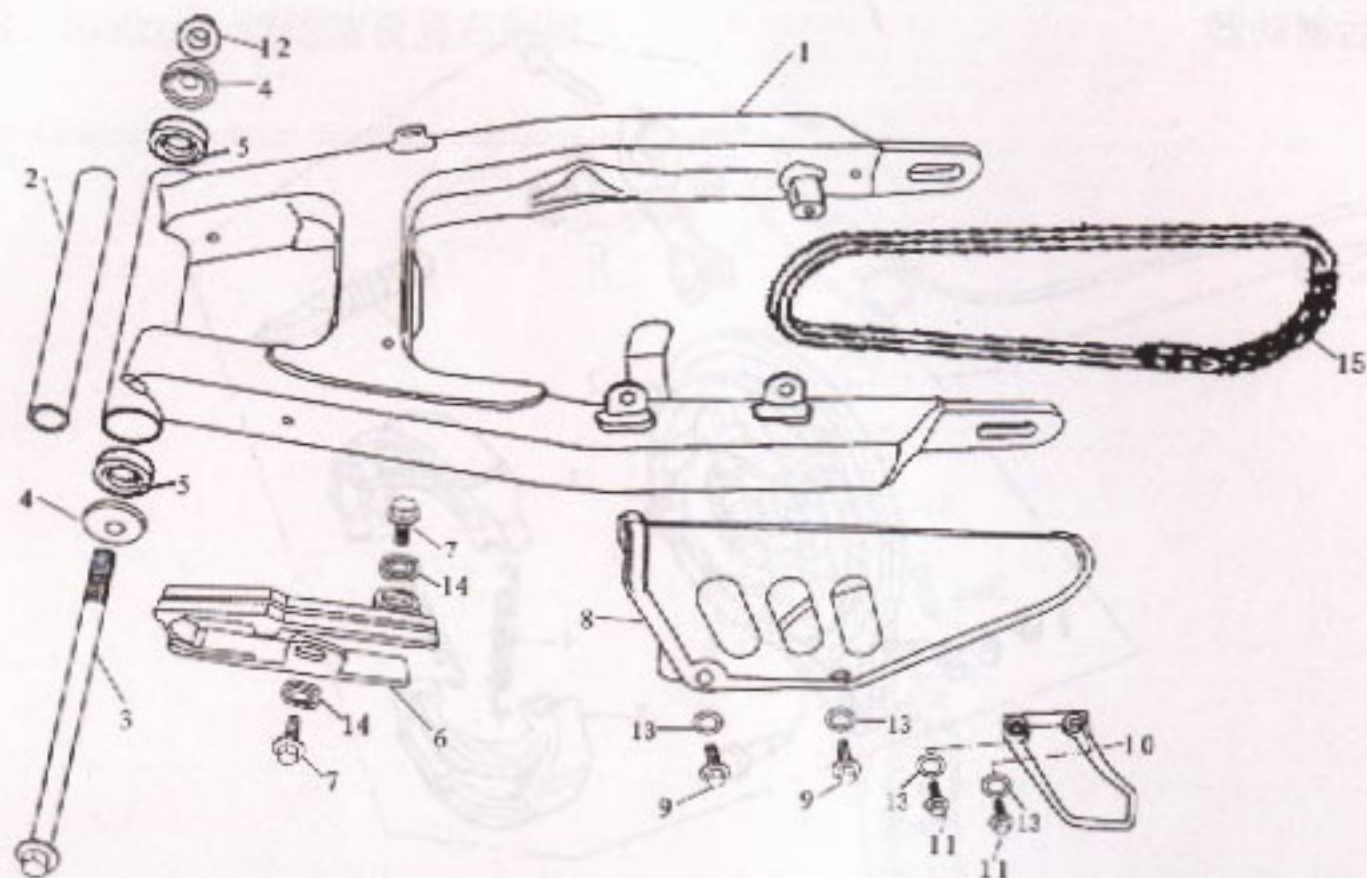

序号 Ref.No.	零部件代号 Part No.	零部件名称及规格	Part Name And Standard	数量 Quantity	备注 Remark
1	VYP(M)000-161000	平叉总成	Fork assy	1	
2	VYP(M)000-161001	平叉衬管	Inner bush, fork	1	
3	VYP(M)000-161004	平叉轴 M12 × 215	Fork spindle	1	
4	VYP(M)000-161003	平叉防尘盖	Dust cap	2	
5	VYP(M)000-161002	平叉内衬套油封	Oil seal, inner bush, fork	2	
6	VYP(M)000-780027	链条护卡	Checkpost, chain	1	
7	GB5783	螺栓 M6 × 16	Bolt M6 × 16	2	
8	VYP(M)000-425000	链盒	Chain cover	1	
9	GB5783	螺钉 M6 × 12	Screw M6 × 12	2	
10	VYP(M)000-161005	下链盒护板	Lower protect plank, chain cover	1	
11	GB5787	螺栓 M6 × 12	Bolt M6 × 12	2	
12	GB6187	螺母 M12	Nut M12	1	
13	GB96	垫圈 6	Washer 6	4	
14	VYP(M)000-161006	链条护卡固定块	Fixing piece, chain checkpost	2	
15	VYP(M)000-211201	链条	Chain	1	

F-19 Rear shock absorber 后减震器

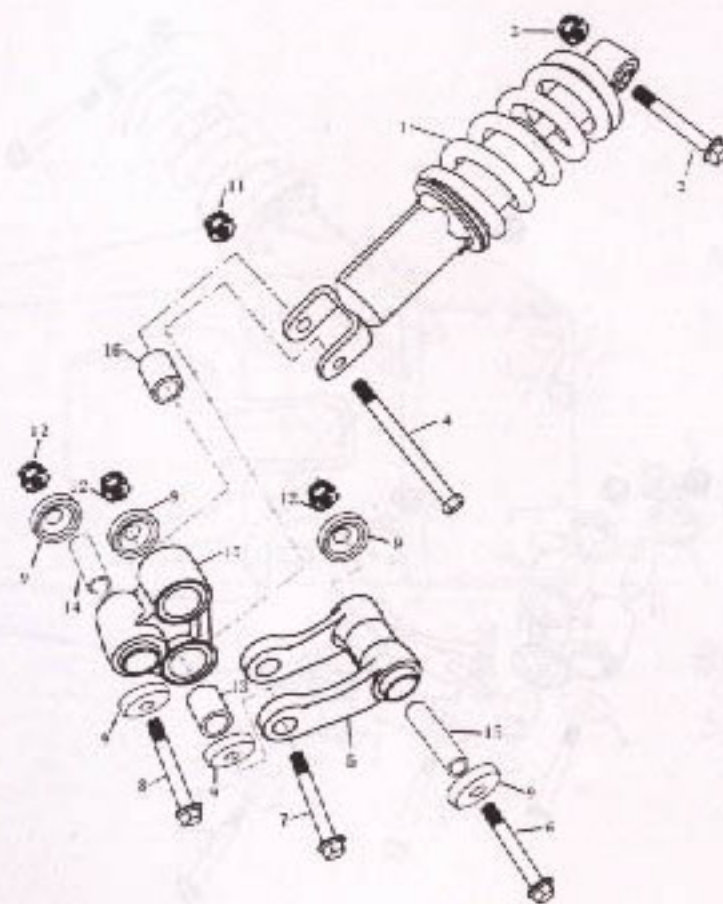

序号 Ref.No.	零部件代号 Part No.	零部件名称及规格	Part Name And Standard	数量 Quantity	备注 Remark
1	VYP(M)000-153000	后减震器	Rear shock absorber assy	1	
2	GB5787	螺栓 M10 × 55	Bolt M10 × 55	1	
3	GB6189	螺母 M10	Nut M8	1	
4	GB31.3-88	螺栓 M8 × 50	Bolt M8 × 50	1	
5	VYP(M)000-153301	车架摇架	Swing frame	1	
6	GB5782	螺栓 M10 × 115	Bolt M10 × 115	1	
7	GB5789	螺栓 M10 × 73	Bolt M10 × 73	1	
8	GB5789	螺栓 M10 × 65	Bolt M10 × 65	1	
9	VYP(M)000-153302	平叉摇架防尘盖	Dust cap	6	
10	VYP(M)000-153306	减震摇架	Swing frame, shock absorber	1	
11	GB6189	螺母 M8	Nut M8	1	
12	GB6189	螺母 M10	Nut M10	3	
13	VYP(M)000-153304	平叉摇架内衬套 1	Tube 1	1	
14	VYP(M)000-153305	平叉摇架内衬套 2	Tube 2	1	
15	VYP(m)000-153303	平叉摇架内衬套 3	Tube 3	1	
16	VYP(m)000-153307	衬套	Tube	1	

F-20 Rear Fender 后挡泥板

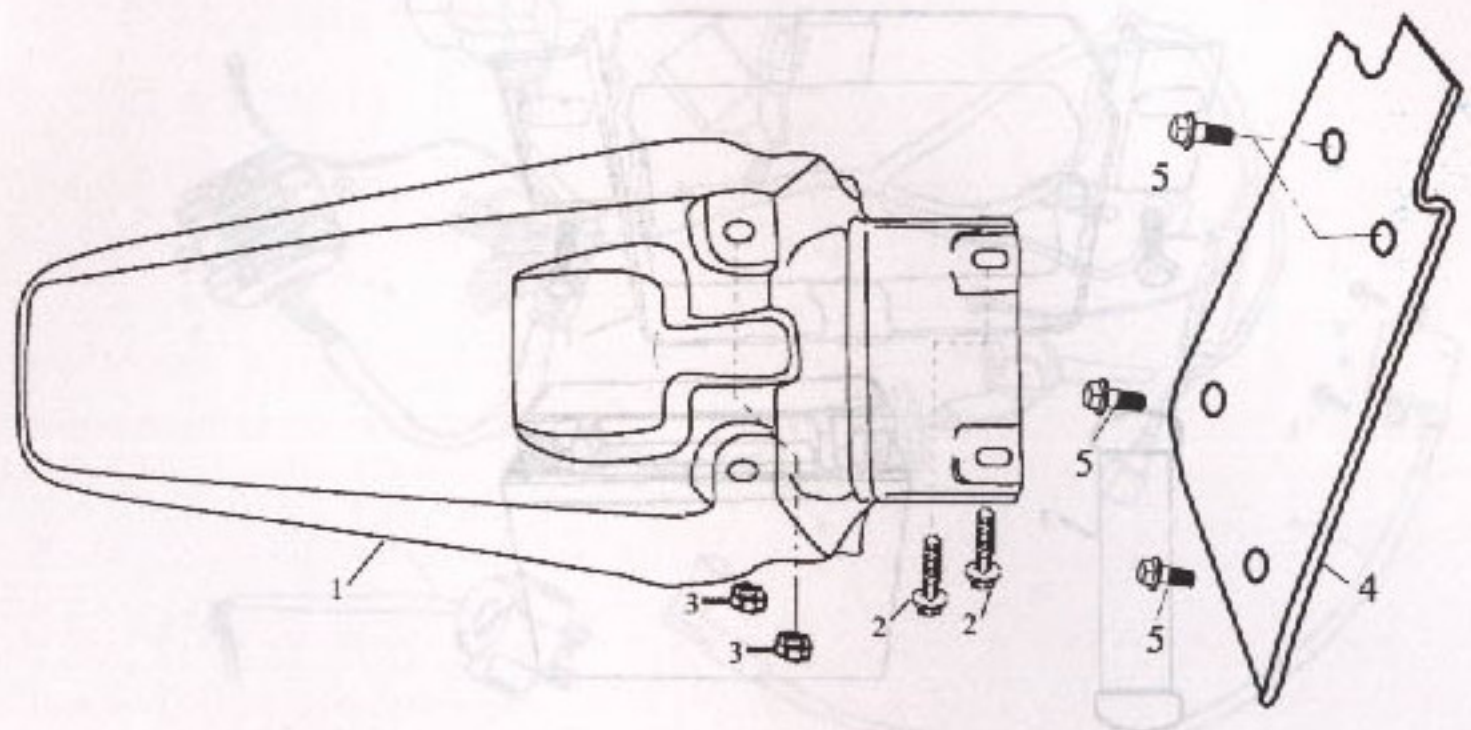

序号 Ref.No.	零部件代号 Part No.	零部件名称及规格	Part Name And Standard	数量 Quantity	备注 Remark
1	VYP(M)000-402003	后挡泥板	Rear fender	1	
2	GB5787	螺栓 M6 × 12	Bolt M6 × 12	2	
3	GB6177	座垫固定螺母 M6	Nut M6	2	
4	VYP(M)000-780015	前挡水胶皮	Fr. breakwater	1	
5	GB5787	螺栓	Bolt	4	

F-21 Battery And Box 电瓶及电瓶盒

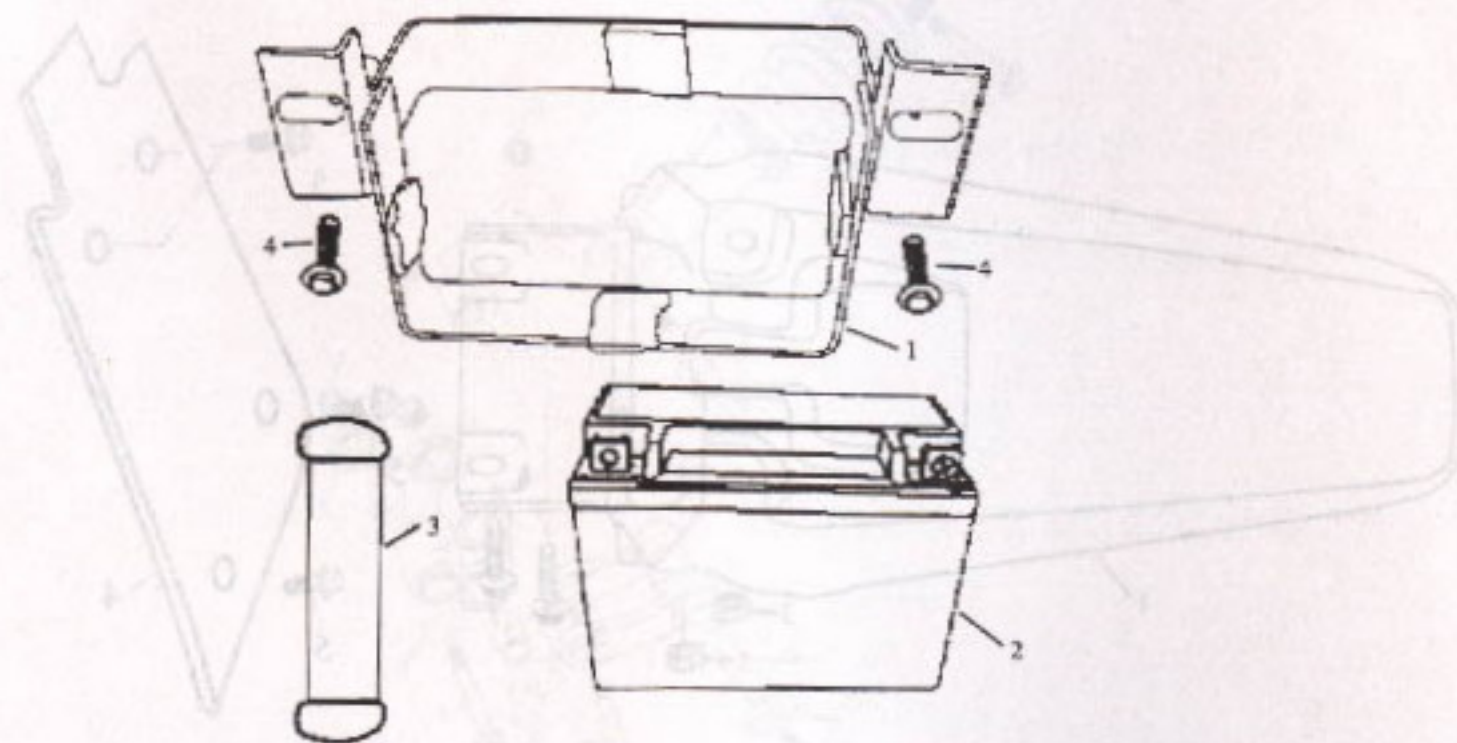

序号 Ref.No.	零部件代号 Part No.	零部件名称及规格	Part Name And Standard	数量 Quantity	备注 Remark
1	VYP(M)000-423000	电瓶盒	Battery Box	1	
2	VYP(M)000-541000	电瓶	Battery	1	
3	VYP(M)000-780031	电瓶扎带	Band	1	
4	GB5787	螺栓 M8 × 16	Bolt M8 × 16	2	

F-22 Electrical 电零件

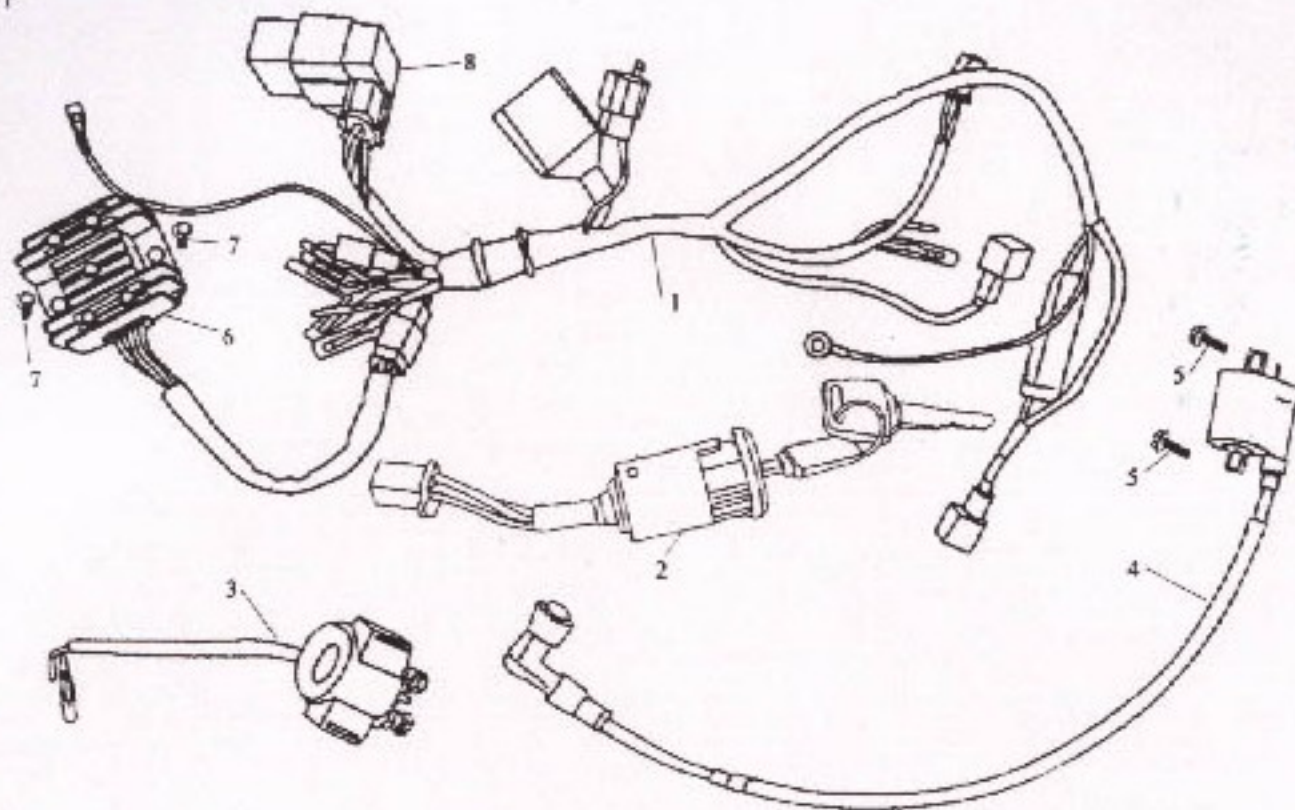

序号 Ref.No.	零部件代号 Part No.	零部件名称及规格	Part Name And Standard	数量 Quantity	备注 Remark
1	VYP(M)000-542100	主电缆	Main Wire Harness	1	
2	VYP(M)000-561000	点火开关锁	Main Switch cock	1	
3	VYP(M)000-569000	起动继电器	Starter Relay Assy	1	
4	VYP(M)000-520900	高压包	Ignition Coil Assy	1	
5	GB5787	螺栓 M6 × 20	Bolt M6 × 20	2	
6	VYP(M)000-530000	调压整流器	Rectifier & Regulator Assy	1	
7	GB5787	螺栓 M6 × 12	Bolt M6 × 12	2	
8	VYP(M)000-520000	点火器	C.D.I. Unit Assy	1	